

Note:

Please confirm your interest to participate in this tender through email to Contract@abrajenergy.com and to submit the EOI & confidentiality declaration forms to be duly filled and send to us for our records **within 3 days of receiving this invitation.**

You will receive a link to submit your proposal through SAP Ariba System

The submission deadline is **as per SAP Ariba System**



Tender Document

Tender No. STC.251211.OPS.8000577

Tender Title: Rate Agreement for the Rebuild, Refurbishment, Repair, Renovation, and Upgrade of Rig 103, 104, 105, 201, 202, 203, 204, Including Main and Mini Camp Facilities

Contents

1. INVITATION TO TENDER	4
2. INSTRUCTIONS TO BIDDERS	5
3. ABRAJ STANDARD TERMS & CONDITIONS.....	13
FORM OF TENDER	14
Annexure- 01 Scope of Work	16
Annexure - 02 Expression of Interest	56
Annexure – 03 Interest to Participate in Tender and Confidentiality Declaration for Tender	57
Annexure – 04 Declaration to Comply with Company Requirement	59
Annexure – 05 Form of Tender Bond.....	60
Annexure – 06 Form of Performance Bond.....	61
Annexure – 07 Form of Advance Payment Bond.....	63
Annexure – 08 In Country Value (ICV)	64
Annexure – 09 Clarification Request.....	67
Annexure – 10 Pricing Schedule	68
Annexure - 11 Tender Strategy for Evaluation of bid	69
Annexure – 12 Deviations Form-Technical Submission	72
Annexure – 13 Deviations Form-Commercial Submission	74
Annexure – 14 Standard Terms and Conditions	76

1. INVITATION TO TENDER

Abraj Energy Services SAOG “the Company” invites ‘Bidder’ to Tender for the Work or Services in accordance with the terms and conditions set down in the Tender Documents. If you are a successful Bidder you shall be required to enter into a Contract in accordance with the Form of Agreement.

STC.251211.OPS.8000577, Rate Agreement for the Rebuild, Refurbishment, Repair, Renovation, and Upgrade of Rig 103, 104, 105, 201, 202, 203, 204, Including Main and Mini Camp Facilities

There should be no indications or markings on envelopes or the parcel, which may reveal the identity of the Bidder except Tender No and Title. The parcel should be delivered on the date and time as specified in the advertised invitation of this Tender and should be addressed to:

Abraj Energy Services (SAOG)
Airport Heights, Seeb, Muscat, P.O. Box 1156, Post Code 130
Sultanate of Oman

Abraj Energy Services SAOG is not bound to accept the lowest Tender or award the full Bidder scope of work and reserves the right to reject any or all Tenders without assigning any reason

2. INSTRUCTIONS TO BIDDERS

2.1 General

Bidders must notify the Company immediately if they find discrepancies omissions or ambiguities in the description of the services or specifications of goods.

Bidders should note the restrictions set out in the Contract regarding the subcontracting and assignment of any part of the Contract to other companies.

Bidders should also note those terms peculiar to the conducting of services in the Sultanate of Oman, including the requirements set out in the Contract for use of Omani supplies, equipment, machinery, consumables, Omani workers and subcontractors, and the importation of materials, equipment and consumables.

By submitting a Tender, the Bidder is deemed to have made the necessary allowances in the Tender Price for adhering to all laws, rules, regulations, Policies, and procedures applicable in the Sultanate of Oman.

Clarification Requests: All questions or communications regarding this Invitation to tender shall be directed by e-mail to Contract@abrajenergy.com before the clarification closing date.

Any addendums, clarifications or any other correspondence will be issued and sent via e-mail to all Bidder during the tendering period.

The Tender Documents and all Tender submissions are to be made in the English language.

2.2 Expression of Interest

The bidder will confirm the Express of Interest (EOI) for the Tender as per Annexure-02 and provide the documents as per following:

To register your interest please complete the forms listed below duly signed by authorized signatory and submitted within three (3) days of reviewing the Invitation to Tender (ITT) to:

Contract@abrajenergy.com

1. Annexure-03 Interest to Participate in Tender and Confidentiality Declaration (Form #AES-03) 2. Annexure-04 Declaration to Comply with Company Requirement (Form #AES-04)

2.3 Confidentiality

All recipients of tender documents (whether they submit Tenders or not) shall treat the details of the documents as private and confidential.

During the tender period, the Bidder shall not communicate with anyone related to or deemed to be related to the owner or custodian of the project unless expressly so directed by the Abraj Contract department or where such communication shall constitute an enquiry as set down in these instructions.

2.4 Clarification Requests

All Clarification Requests regarding this Tender shall be submitted by Bidder in the format as included in Annexure 09.

The request for the extension of Submission Bid will be provided well within 5 days from receipt of the Tender Document and the extension of Bid will be requested in same form of Annexure-09.

Company reserves the right not to entertain any Clarification Request received by Company after the Clarification Request Closing Date stipulated in the Tender schedule.

Addenda to the Tender Documents may be issued prior to the date of delivery of Tenders for the purpose of amending or clarifying the Tender Documents. Should there be any doubt or obscurity as to the meaning of the Tender Documents, or as a request for a site visit, or as to anything to be done under the Contract or concerning these instructions, or any other matter, the Bidder must set forth in writing such doubt or obscurity and deliver the same to Abraj Tender Committee, not later than ten **(10) working days before the date fixed for the submission of Tenders**. If considered appropriate a reply in the form of a Circular Letter or Addendum will be distributed to all Bidders who have obtained the Tender Documents.

Company will endeavor to revert within 2-3 working days from receipt of Clarification submissions as per Tender Schedule below.

2.5 Preparation of Bids

The scope of work has been attached herein in Annexure- 01. The technical Bid should be provide to meet the requirement specified in scope of work.

Any bid exceptions must be attached to the bid. Exceptions to the provisions of the contract will not be accepted by Company for review or negotiation after the bid closing time. Exceptions shall be accompanied by complete information on the nature and extent of the proposed exception and the consequent impacts to the prices, schedule or other aspect of the bid.

Bidders will not be compensated for the cost of preparing a bid, including, without limitation, any travel costs, whether successful or unsuccessful and regardless of whether Company chooses not to award the contract.

Bidders are encouraged to provide any additional information helpful to Company in evaluating their bids.

Bidder shall submit their bid in accordance with Tender documents and provide information as per attached Annexures wherever required.

Bidder shall ensure upon receipt that the copy of the Tender Documents has received in complete and inform if they have not received any of mentioned above to Contract Administration on email address Contract@abrajenergy.com with five (5) days after received of mail.

All copies shall be properly executed, all blank spaces shall be filled in, and any interlineations, alterations, or erasures shall be formally explained and initialed by the Bidder. Failure to comply with these requirements may be cause for rejection of the bid.

Bid may not be considered unless they are in conformity with the Tender Documents. You are specifically advised that evaluation of BID shall include the degree of exceptions taken (if any) to the Body of terms and conditions.

Bidder shall confirm acceptance of the proposed terms and conditions together with any exceptions, clearly shown in the Tender documents. Partial or incomplete BID received after the stated due time may be rejected.

Each Bidder shall give the full legal name, registered number, place of incorporation and registered office address of the Bidder. Where the Bidder operates under any trading name this also shall be stated, as shall be any trading or mailing address if different to the registered office address.

BID shall be written in English and labelled with the name of the part inside.

The Bidders should Submit following documents in the Technical Bid submission:-

- a. Maximum technical information of all the services or equipment covering the Scope of work as per attached Annexure-01.
- b. Specification, brand name, manufacturer name, material detailed, etc. maximum information of each component or part of all equipment or assembly of Equipment.
- c. List of Certificates. If possible, sample of certification.
- d. Country of Origin of Raw Material and Assembly of equipment.
- e. Product drawing or assembly drawing with maximum information.
- f. Part Catalogue or Product catalogue.
- g. Manufacturer experience detailed.
- h. List of Customer to whom you are dealing.
- i. Any other information which can be useful for technical evaluation of scope of work as per attached Annexure- 01
- j. Deviation to our requirement will be marked separately and any change in price will be provided in Commercial BID.
- k. For any additional Item or scope of work should be specified with optional price.
- l. Bidder should provide detailed product specification along with catalogue copy in Technical BID.
- m. All items should be supplied as per latest standard of American Petroleum Institute.
- n. This is general standard of the equipment required in Oil and Gas Industries.
- o. Purchaser should have right to select line item in the bid.

- p. The Technical Tender shall not contain any pricing information.

The Bidders should Submit following documents in the Commercial Bid submission:-

- a. Submit your price for the equipment as per attached Price Schedule Annexure -10. The total price need to be carried to the Form of Tender and complete all blanks applicable in the Appendix of Form of Tender.
- b. Price of each equipment or group of equipment as per scope of supply as per attached Annexure –10.
- c. Provide Delivery period. - Abraj expects to get better delivery and the delivery is one of the criteria of commercial evaluation.
- d. Provide clear delivery term.
- e. Packing charges if any required.
- f. Manufacturer of each item of Equipment or assembly of Equipment.
- g. Country of origin of each item of Equipment or assembly of Equipment.
- h. Provide additional information which can be useful for commercial evaluation of scope of supply as per attached Annexure-01.
- i. Commercial Part shall be submitted with prices and rates in US \$/OMR taking into account the Works to be executed with terms and conditions included herein.
- j. Technical and Contractual Part shall be submitted with the format and content specified hereinafter. No prices shall be indicated in the technical and contractual part.

2.6 Visit to the Site (If Required)

The Bidder must visit the Site and obtain, at his own expense, all information necessary for preparing a Tender. He must carefully examine the Tender Documents and satisfying himself as to the tasks, risks, obligations and responsibilities to be undertaken in the Contract, form and nature of the entire areas in which the Works are to be carried out, the means of access to the Site and in general all other matters which may affect his tender.

Any neglect or failure on the part of the Bidder to obtain reliable information at Site or elsewhere or on any other matters affecting the execution and completion of the Works of this Contract shall not relieve the accepted Bidder from any risks or liabilities or from the responsibilities of completing and handing over the works.

Abraj Energy Services will arrange a guided Site Visit and a notice to this effect will be issued during the tendering period. The Bidder shall contact Contract Administrator/ Contract Engineer through Email regarding the time and date of the guided Site Visit.

Any of the employees, servants or agents of the Bidder will be allowed by Abraj to enter the site and his premises and land for the purposes of inspection and examination strictly on condition that such persons, firms or companies will indemnify the Company and his servants and agents from and against all liability arising out of any personal injury, fatal or otherwise, loss or damage to property and any other loss directly or indirectly attributable to the said inspection and examination.

2.7 Submission of Bids

The Tender shall be submitted in two parts: one comprising a Technical Tender and one containing the Commercial Tender. The Technical Tender shall contain all the required documents requested in the Tender Documents excluding any financial references. The Commercial Tender shall contain all financial documents and information. Bidders who fail to adhere to this requirement will result in the disqualification of their Tender.

The Bid Form together with all information and documentation shall be completed and submitted by email only.

The bidder must affix its initialed company stamp to every page of its original Tender submission which should include all parts of the Tender Documents. The original shall be clearly marked "ORIGINAL"

Bidders not complying with the requirements of the Bid Form and the submission and delivery of the bids may be deemed non-responsive to the Invitation to Tender and their bids may be excluded from further consideration.

The Bidders should submit the bids which should be signed by Authorized person of the company and company may verify if it is required from CEO or Owner of bidder or any other Agencies e.g. Chamber of Commerce. .

No deletions or erasures may be made in the list of prices and the schedule of categories. Any correction in the prices etc. shall be re-written in numbers and words and signed by the authorized person.

The bidder may not delete or modify any clauses or technical specifications irrespective of the nature of such modification.

Any special conditions or modifications shall be sent in or attached with a separate letter kept in the tender envelope. A reference shall be made to this letter in the bid itself. No other alternative shall be acceptable.

The price schedule shall specify whether the item is manufactured in the Sultanate of Oman or abroad. Inaccuracy of the information submitted, partly or fully, shall lead to the rejection of the item without prejudice to the Abraj Tender Committee's right to deprive the bidder of the facility to deal with other tenders of the Company within a period specified by the relevant Abraj Tender Committee (ATC), depending on the situation of each case.

The prices quoted by the bidder in the schedule of categories shall include and cover all the expenses and liabilities, irrespective of their nature, to be incurred or met in respect of each clause and shall also include those involved in the completion, delivery and maintenance if required, of all the works during the period of guarantee and maintenance.

The final calculation shall be done on the basis of these prices irrespective of fluctuations in the market, the customs duty and other duties and taxes.

The bidder shall, in case of the submission of one or more alternative offer, ensure that these offers are clear and detailed and referred to in the list of contents.

If the bidder fails to specify the price of an item required to be supplied in the price list, this shall be considered as abstention from participation in the tender in respect of such item.

The prices specified in words shall be accepted. As an exception, the relevant may accept the offer specified in numbers only in the Company's interest.

A bid based on a reduction in the lowest bid by a specified percentage shall also not be acceptable.

To submit the Commercial bid, the following shall be taken into account:

- a. If the goods are required to be delivered on board the ship, the price given in the bid shall include the price of the items, adding thereto the expenses for mobilization, transportation and loading in accordance with the FOB system.
- b. If the goods are required to be delivered at the port of arrival, the price given in the bid shall include the price of the items, adding thereto the expenses for mobilization, transportation, loading and shipping in accordance with the C & F system.
- c. If the goods are required to be delivered at the port of arrival, the price given in the bid shall include the price of the items, adding thereto the expenses for mobilization, transportation, loading, shipping, insurance and unloading in accordance with the CIF system.
- d. If the goods are required to be delivered at the stores of the purchaser or the work sites, the price given in the bid shall include the price of the items, adding thereto the expenses for mobilization, transportation and loading, the shipment charges, the insurance cost and expenses on unloading, customs duties, internal transportation and other additional charges.
- e. In all cases, the contractor shall bear all the expenses for getting the letter of credit from the Company pertaining to their banker while the Company shall bear the letter of credit opening charges pertaining to its banker in Oman.
- f. The data or information for Commercial Bid submission will be as per attached Annexure-10.

Bidders accept full responsibility for ensuring their bids are delivered or submitted to the correct email address by the specified deadline. Bids submitted to any other address or later than the deadline may not be considered.

Bidders forwarding their bids by courier should advise by email to Contract@abrajenergy.com, when the bid has been sent by courier, naming the courier and tracing number.

Bids received after the final bid submission deadline will be returned unopened to the bidder.

Company expressly reserves the right to extend the bid submission deadline.

2.8 Currency of Contract

The currency of the contract will be in Omani Rials (OMR) or US Dollar. In the case of a tender submitted by an individual or companies abroad, it is permitted to write the prices in foreign currency provided the equivalent Oman currency must be mentioned. Tender in foreign currency without the equivalent Oman currency will be rejected.

2.9 Validity of Tenders

The Bid Proposal shall remain valid and irrevocable for a period of Ninety (90) days from the closing date for the submission of Tenders. Company intends to notify all Bidder of the result of their Tender submission during this period. If Bidder retracts or withdraws its Tender during the period of its validity without receiving authorization from Company, Company may, at its sole discretion, without the need for summons, notice or other legal formalities or exercise any other rights stipulated in the Tender Documents.

In exceptional circumstances, prior to expiry of the original, the procuring agency may request the bidders to extend the period of validity for a specified additional period, which shall not be for more than one third of the original period of bid validity. The request and the responses thereto, shall be made in writing. A bidder may refuse the request without the forfeiture of the bid security. In case, a bidder agreed to the request, shall not be required or permitted to modify the bid, but will be required to extend the validity of the bid security for the period of the extension

2.10 Language of Contract

All correspondence with the Company or the Company's representative shall be in the English Language. Original documents or copies submitted by Tenders, which are not in Arabic or English, should be accompanied by English translation.

2.11 No Alterations

No Alterations to the text of the Tender Documents shall be made except for filling in blanks intended to be filled-in. Failure to fully comply with this instruction may result in the rejection of the Tender.

Any alteration to a unit rate or amount made by the Bidder to correct clerical errors entered by him in the Schedule of Prices and Schedule of Rates during the preparation of the tender must be initialed by the person authorized to sign the Tender prior to the submission of tender.

2.12 QHSE Requirements

The Supplier shall comply with all the HSE requirements of Abraj Energy Services (S.A.O.G). As specified while executing the required supply works. Bidder shall fully describe its HSE record for the last three years. This shall include details of accidents and incidents involving Bidder's personnel and third parties for the activities undertaken by Bidder.

2.13 Bidder Registration Requirements

The successful bidder(s), who are not already registered, will be sent a supplier registration form and will have up to 30 days to register with Abraj Energy Services. The request need to be send to following email address to get the necessary documents required to complete registration process:

Email Address: Contract@abrajenergy.com

2.14 Opening of Tenders

Both Technical & Financial Offers submitted will be opened at the time and day specified in the advertised invitation to Tender at the offices of Abraj Energy Services. Any Tender received after the time and date fixed for submission of Tenders will be rejected.

2.15 Tender Bond

The Bidder must furnish, as part of his Tender, a Tender Bond in the value of not less than 1% of the Tender Value. If the Bidder submits an alternative Tender, the one percent shall be calculated based on the highest Tender Value. The wording of the Tender Bond shall be as per the prescribed Form of Tender Bond included within the Tender Document. See Annexure-14.

The Tender Bond shall be denominated in Omani currency and shall be obtained from a bank located and registered in the Sultanate of Oman and valid for ninety (90) days from the latest date fixed for the submission of Tenders. Any Tender not accompanied by a Tender Bond will be rejected.

The Tender Bond of unsuccessful Bidders will be returned on its expiration or after the award of the Contract to the successful Bidder.

The Tender Bond will be forfeited:

- i) If a Bidder withdraws his Tender during the period of Tender validity specified in the Tender Documents; or
- ii) In the case of a successful Bidder, if the Bidder fails:
 - a) to sign the Contract; and/or
 - b) To furnish the Performance Bond.

2.16 Performance Bond

For the due performance of the Contract, The Supplier will be required to provide a Performance Bond within (7) calendar days from the date of the Letter of Acceptance to the value of five percent (5%) of the Contract Value, obtained from a Bank registered in the Sultanate of Oman, and valid for the whole of the Contract and Defects Liability Period. The Performance Bond will be retained by the Company during the Contract and Defects Liability Period and will be returned to the Supplier upon the satisfactory completion of the Defects Liability Period. The Performance Bond shall be as per the prescribed "Form of Performance Bond" included in the Tender Document.

2.17 Evaluation of Tenders

After received of Bids, Abraj evaluation Team will conduct evaluation of Bid. Technical and Commercial bids will be evaluated separately by different Evaluation Team. Tender evaluation Strategy of bids will be conducted as per Annexure-11.

2.18 Award contract

Abraj reserves the right to reject all of the bids for any reason and not award the Contract to any Bidder.

Abraj reserves the right to award the Contract to a Bidder other than the lowest Bidder and to negotiate any amendment to the terms of the contract with the successful Bidder.

Abraj reserves the right to seek clarification from bidders during the evaluation process.

Bids will be evaluated by Company to determine the best qualified and most competitive.

Bidder taking into consideration all aspects of the bid, including but not limited to:

- a. The bidder's technical ability to perform the job to Company specifications and the suitability of the proposed equipment, tools, goods, processes and programs.
- b. The rates offered.
- c. Bidder's financial integrity, past performance, reputation within the industry.

In the event that Company estimates that the bid price exceeds competitive limits, it may request the bidder to reconsider the bid price with the aim to lower the price, and such a request shall not be considered as a rejection or acceptance by the Company until the validity period specified herein.

Notification of Acceptance: By way of a Letter of Intent to Award, Company shall notify the successful Bidder of Company acceptance of its Tender subject to the following conditions precedent: Signing of the Contract.

For the purpose of determining the start dates of the Performance Bond and the Insurances, the date of the Letter of Intent to Award shall be used unless another date is otherwise stipulated in the Letter of Intent to Award. If the successful Bidder fails to submit the documentation per (a) and (b) above within the time period stipulated in the Letter of Intent to Award, Company may, at its sole discretion, without the need for summons or notice or other legal formalities, exercise any rights stipulated in the Tender Documents, and notify the successful Bidder that the Contract is, ipso facto, terminated. The Effective Date, as entered in the Agreement, shall be determined at the sole discretion of Company.

3. ABRAJ STANDARD TERMS & CONDITIONS

Abraj's standard terms and conditions are attached as per Annexure 14 and any deviation to terms and conditions should be specifying in Commercial Bid.

Company expressly reserves the right to extend the bid submission deadline. Bidders not complying with the requirements of the Bid Form and the submission and delivery of the bids may be deemed non-responsive to the Invitation to Tender and their bids may be excluded from further consideration.

Bidders accept full responsibility for ensuring their Bids are delivered to the email addresses by the specified deadline. Bids submitted to any other email address or later than the deadline may not be considered.

FORM OF TENDER

STC.251211.OPS.8000577, Rate Agreement for the Rebuild, Refurbishment, Repair, Renovation, and Upgrade of Rig 103, 104, 105, 201, 202, 203, 204, Including Main and Mini Camp Facilities

To:

Abraj Energy Services (SAOG)
 Heights, Seeb, Muscat, P.O. Box 1156, Post Code 130
Sultanate of Oman

Sir/Madam,

1. We have examined the Conditions of Contract, Company's Requirements, and Addenda listed hereunder for the above named Works. We have examined, understood and checked these documents and have ascertained that they contain no errors or other defects. We, the undersigned accordingly, offer to execute and completely maintain the whole of the said Works for the prices set out in our Tender.

Rials Omani

(R.O.) or such other sum or currency*

(.....)

2. We undertake if our Tender is accepted to commence the work in accordance within Days of the Contract Conditions and to complete the Works in accordance with the above documents within the time for Completion stated in the Appendix to the Form of Tender. We guarantee that the Works will then conform to the Performance Guarantees included in this Tender.
3. We undertake that if our Tender is accepted we will provide the specified Performance Bond from a locally registered Insurance Company or Bank in accordance with SubClause 2.16 of the above instruction to Bidder to be jointly and severally bound with us in the sum of five percent (5%) of the Contract Price for the due performance of the Contract under the terms of a Performance Bond to be approved by you.
4. We agree to abide by this Tender for a period of 90 days from the date fixed for receiving same and it shall remain binding upon us and may be accepted at any time before the expiration of that period.
5. Until the Contract is prepared and executed this Letter of Tender, together with your written acceptance thereof, shall constitute a binding obligation upon us.
6. We understand that you are not bound to accept the lowest or any tender you may receive.
7. We acknowledge the receipt of the following Circular Letter and Addenda:

Reference number of Addenda:

Date

.....

.....

.....

.....

And confirm that we have taken account of same in our Tender.

8. We confirm that we have an Agent/s for the provision of Spare Parts, Maintenance Services and repair who are:

Name _____

Address_____

And whose Agency Registration Number is _____

Dated_____

Name _____

Address_____

And whose Agency Registration Number is _____

Dated_____

Annexure- 01 Scope of Work**Objective**

Abraj Energy Services (AES), since it was founded in May 2006, has taken major strides and has rapidly grown to become a strong player in the Oil and Gas market. AES specializes in Drilling and Oilfield services as well as Well Engineering Solutions. Within few years of its establishment, AES has achieved a remarkable place in the local market providing solutions and services in a safe environment and up to customer satisfaction. Lately Abraj has expanded its operation outside Oman and started operation in Kuwait.

Subject

Rate Agreement for Rebuild, Refurbishment, Repair, Renovate & Upgrade Rig 103, 104, 105, 201, 202, 203, 204 Camps

Project Background

The existing drilling rig camp is approximately 10 years old and has deteriorated due to continuous operation and exposure to harsh environmental conditions. The camp requires a major overhaul and full renovation to restore safety, living standards, and operational readiness for upcoming rig deployments.

Project Objectives

- Restore the camp to safe, habitable, and compliant condition.
- Upgrade infrastructure to extend service life
- Improve comfort and hygiene for crew members.

Scope of Work

The following scope of work has been developed to define the demand for services required for Rate Agreement for Rebuild, Refurbishment, Repair, Renovate & Upgrade Rig 103, 104, 105, 201, 202, 203, 204 Camps.

- This is a call-off contract which means Abraj will decide the quantity needed for each service and line items.
- Bidder shall state the number of cabins, Skids... etc that are gaining for Rebuild, Refurbishment, Repair, Renovate & Upgrade for each camp as stated in the commercial evaluation.
- Below Specification shall be met while rebuilding, repairing, refurbishing the cabins & skids.
- All the camps shall design meeting OPAL Standards.
- Bidder shall design the Clinics as per standards and shall get the approval from the MOH and other approvals to have a certified clinic.
- Bidder shall design Camps as per Opal stander and Civil of defense and obtain the approval from both.
- Bidder allowed for face-to-face tender clarification. Abraj reserves the right to cancel any planned job which will be discussed in the meeting after bid

submission. The bidder will be called for a meeting after bid submission for a detailed recertification

- Bidder shall inspect and utilize the old equipment, and any replacement of old equipment shall be done after obtaining the Abraj approval, submitting the inspection report, and documenting that the equipment is beyond repair.
- Bidder shall do Rebuild, Refurbishment, Repair, Renovate & Upgrade Rig 103, 104, 105, 201, 202, 203, 204 Camps and meet the requirements below:

A. General Scope

A.1 Company Mandatory GO NO-GO Technical Requirements	Compliance Yes/No?
a) The mobile camp shall be designed and constructed in accordance with the standards and specifications SP-1110 Specification for Electrical Supplies to Mobile Camp SP-1277 Transportable Accommodation Units OPAL Standard	
b) Camp shall meet at least number of Cabins listed in Appendix 1. This is not limited and depends on the number of cabins available in the existing camp or provided by Abraj.	
c) Camp shall meet the layout listed in Appendix 2. This is not limited and depends on the number of cabins available in the existing camp or provided by Abraj.	
d) Offices should be of integrated design to allow easy interaction between all parties (i.e. separated unconnected caravans are not allowed).	
e) All offices to be fitted with an Uninterrupted Power Supply system (UPS 5KVA, with a minimum of 30 minutes) and a Power Conditioner.	
f) Humidity up to 85%, temperature range: 15 to 55 deg. C, protection against sandstorm ingress & occasional rainstorms. The Top Roof/Walls of the cabin shall be painted with silicone-based thermal and waterproof.	
g) Construction details & materials shall be such that noise level is limited to 45 dB(A) inside the cabins, whether the modules are for the main camp or the site camp, knowing the noise outside, in the vicinity of the modules could be in the range of 65-70 dB(A), and above 90 dB(A) at a 50 ft distance from the modules. The electrical installation shall comply with International Standards such as IEC, or IEEE. The camp shall be designed and constructed to ensure zero sound transmission between rooms and from external sources, incorporating high-performance acoustic insulation materials and construction techniques to maintain internal noise levels not exceeding 45 dB(A)	
h) Toilet & Shower (T/S) cubicles design shall incorporate features allowing easy thorough cleaning and disinfecting, other features shall follow Company HSE standards and policies.	

<p>i) Sleeping rooms will consist of:</p> <ol style="list-style-type: none"> 1. 2 X bed with 5-star sleeping mattress, height of 32cm (2 Nos)- (from Raha) 2. Pillow, (2Nos) (from Raha), Silky Pillow, Dimensions: 50 cm x 70 cm. 3. Bed Sheet (2Nos) 4. Blanket wool (2Nos) 5. Magazine Holder, In house (2Nos) 6. Writing Table with Type C/Electric socket and chair, In house (2Nos) 7. 2-Tier Steel Locker, (2Nos),Dimensions: 78" x 12" x 15" 8. Refrigerator (60 Ltr) (1Nos) (Sharp, LG) 9. TV – 32" (LG,Samsung,Sony) Smart 4K 10. Smoke Detector, Dicon / BRK/Eq. (1Nos) 11. 1.5 ton (Invertor type) Piston big compressor type 410 gas (1Nos)- 2 AC shall be provided for bigger size of room 12. Dual-mode units (cooling/heating) are to be preferred to eliminate the need for separate heaters. 13. Emergency Light, (1Nos). Labeled with phosphoric Emergency sings 14. Bed Lamp, (2Nos), warm white (2700K to 3000K) 15. Door Closer, Yale (1Nos) 16. Fire Extinguisher with Bracket, In-house (1Nos). Inspected one month before delivery (Nafcoo & Bristol) only will be accepted 17. Single Wash Basin 40cm*40cm (1Nos). With soap holder 18. European WC (1Nos)- Wall Mounted 19. Shower Cubicle with curtain (1Nos). With Shower Caddies 20. Water Heater (50 L) (1Nos) – Supplier can provide center heater for each accommodation skid. 21. Emergency exit door with phosphoric labeling 	
<p>j) The Bathroom Area shall be covered with Wet Area Panel Board- (Wood Polymer Composite- WPC Panel, which is water-resistant and anti-termite). Bathroom level should be designed with a proper slope to allow water to drain</p>	
<p>k) Cabinets and desktops are built from 18 mm MDF with plastic laminate bonded to both sides, and natural light wood trim on the edges. Individual cabin & change room lockers will be supplied with locks allowing use of a padlock. Drawers will be provided with restraining devices (locking them in closed position) for the rig moves, for the same reasons, cabinet doors shall be fitted with push / pull open locks, and bookshelves shall have book / binders holding devices.</p>	

l) Internal wiring is in accordance with IEE regulations, latest edition, suiting 220 V – 60 Hz or 50 Hz (to be confirmed upon order). Wiring is all concealed, with main cable runs above the corridor ceiling (one for each section). Surface mounting is only allowed in the galley (pipes), and for the computer / LAN, UPS & communications network in Offices (PVC trucking - however not for the main electrical wiring). Each building is provided with 2 Nos Distribution Panels (DP), IP42 or NEMA 1 Class, make Schneider fitted with a 30 mA RCD in the incoming circuit, and 2 poles circuit breaker for single phase distribution, 3 poles circuit breaker for 3 ph w/out neutral, and 4 poles circuit breaker for 3 ph & neutral. All outgoing circuits shall be protected with circuit breakers; both are internally connected after assembly of the 2 half-sections as to require only a single power cable to the building. Power cable will be as per the layout. The cable will be permanently gland to the building DP and fitted with a male plug at the other end. A cable rolling support shall be provided at the end of the skid.	
m) Sockets are 13 amp switched BS 3 pins type 220 V single phase (Make: Schneider), Each accommodation room has a double socket outlet. Each building is fitted with cabling system for TV/Dish system and computers. For these JB's, they shall be provided at the service end of the building/module.	
n) A complete CCTV surveillance system shall be designed, installed, and commissioned to monitor all critical areas of the camp and site, including entry/exit points, perimeter boundaries, common areas, generator rooms, and critical utility zones. The system shall include high-definition (HD) IP cameras with night vision and motion detection capability. Cameras shall be weatherproof (IP66 or higher) and vandal-resistant. The system shall be connected to a central Network Video Recorder (NVR) with a minimum of 30 days storage capacity and remote access capability. The entire system must comply with relevant cybersecurity and data privacy standards. All cabling, power supply, and network connections must be concealed and secured in compliance with international standards.	
o) Beds shall include lockable drawers in their base, and be fitted with headboard, individual bookshelf and individual bed light.	
p) Kitchen, mess, recreation, laundry, ablution, dry and refrigerated food storage facilities in accordance with SP-1232 . A separate chiller room to be provided.	
q) Clinic to be situated at camp site and be furnished/equipped in accordance with Company's HSE standards in SP1232 . Clinic to include but not be limited to an ECG machine with defibrillator (capable of transmitting data electronically). Clinic drawings should be approved by MOH	
r) Clinic shall be approved by MOH	

<p>s) A dedicated, air-conditioned prayer room shall be provided for Muslim staff, with a minimum capacity of 15 persons. The unit shall be fully furnished and equipped with carpet flooring, a Qibla direction indicator, a bookshelf for storing Holy Qurans, and a digital prayer time display board. Proper ventilation and lighting shall be provided, and all finishes must be suitable for easy cleaning and maintenance. The prayer room must be constructed in compliance with HSE requirements and approved camp layout. Electrical connections shall be provided for lighting, fans, and prayer clocks as required.</p>	
<p>t) A complete Reverse Osmosis (RO) water purification system shall be installed at both the rig site and the main camp to provide a continuous supply of potable water. Each RO plant shall be of minimum capacity 150 GPM, brand Aqua Pro (or equivalent approved by the Company), and shall be equipped with a minimum of two sets of pre- and post-filtration units to ensure water quality meets WHO drinking standards. The system shall include feed water pumps, pressure vessels, membranes, control panel, and automatic flushing. Units must be housed in weatherproof and insulated enclosures with proper drainage. All equipment shall be corrosion-resistant and suitable for desert operational conditions (temperature up to 55°C). Full documentation, including testing reports and operation manuals, must be submitted and approved by the Company prior to commissioning.</p>	

<p>u) A complete firefighting system shall be provided for the main camp and site camp in full compliance with PDO, NFPA, and local civil defense requirements. The system shall include:</p> <p>Fire Extinguishers: Minimum two (2) portable fire extinguishers per cabin/skid, with wall-mounted brackets. Only approved brands (e.g., Bristol or Nafcoo) inspected not more than one month before delivery shall be accepted. Serial number bracket to be available.</p> <p>Fire Hose Reels and Hydrants: Strategically placed around the camp, connected to a pressurized water supply. Hose reels shall be 30m length, 1" diameter, with nozzle, enclosed in weatherproof cabinets.</p> <p>Fire Alarm System: Centralized addressable fire alarm panel (Bristol or equivalent) with smoke detectors, manual call points, sounders, and external alarm beacons installed across all cabins and utility areas.</p> <p>Generator & Fuel Storage Protection: Dedicated fire alarm system inside the generator room and fire extinguishing coverage around diesel tanks, with flame arrestors and emergency shutoff.</p> <p>Signage & Markings: Emergency exit signage, fire point identification, and fire system labeling must be clearly displayed as per standard.</p> <p>All fire systems must be tested, commissioned, and certified by an approved third-party before handover.</p>	
<p>v) All drawings / Equipment technical specs to be approved by Abraj before commencement of fabrication.</p>	
<p>w) Each camp and rig site unit shall contain the followings:</p>	
<p>1. The cabins with built in skids and master skids shall be fabricated as per details of approved drawings by Abraj.</p>	
<p>2. The cabins shall be fabricated using mild steel (MS) profile sheets of 3 mm conforming to IS 2062 Grade E250 or equivalent international standards.</p>	
<p>3. Steel structure after sweep clean shall be coated with Epoxy primer and top coat Polyurethane epoxy paint system, white. Building & master skids shall be sandblasted (in/outside) to Sa 2.1/2 and coated with a 3 coats epoxy system. All the steel work is blasted to Sa 2.1/2. Coating based on a 3 coats epoxy system with 25 micr. epoxy Primer, 150 micr. HB epoxy, and 50 micr. Polyurethane finish. Internal of the buildings will only be coated with 25 micr. Primer.</p>	
<p>4. The master skids to be used shall be of I- Beams of size 400 x 200 x 56.5Kgs (as minimum) the master skids and built in skids of the cabins shall be coated with coal tar epoxy. All the</p>	

steel work is blasted to Sa 2.1/2. Coating based on a 3 coats epoxy system with 25 micr. epoxy Primer, 150 micr. HB epoxy, and 50 micr. Polyurethane finish	
5. Master skid shall be capable to handle 1.5 times of full cabins weight. Clear label to mentioned on the lifting points	
6. The internal of the cabins shall be insulated with rock wool of 50 mm thick and top MR (Moisture Resistant MDF) MDF finish of 12mm thick to be fixed.	
7. The cabin flooring will be of 18mm Marine plywood, the underneath plywood will be painted with coal tar epoxy to avoid rusting and soaking.	
8. The cabin floor of 18 mm Marine ply wood will be nut bolted with Lock Nut the main bottom angle frames to ensure the flooring is firm and does not come out during camp moves.	
9. All rooms shall have a dedicated toilet GRP Cubicle Type. All GRP should be installed properly and have no any damage after installation	
10. All water outlets in both offices & camps shall have separate cold and hot lines. Potable Water used for shower in the rig site and campsite accomodation shall be cooled down for use during summer months. (PPR Piping Brand Techno Pipes). The Pipe shall have easy disconnection between cabins.	
11. The toilet / shower shall be GRP Cubicle Type. Hand trolled is not acceptable fitted with EWC- Laufen Swutzerland, shower cubical, water heaters- AO Smith, GRP washbasin with mirror, exhaust fan- KDK. Internal floor finish in rooms shall be of. Vinyl Sheet Heavy Duty Type Brand Tarkett Spain Thickness 3mm Heterogeneous Sound deadening Type.	
12. All camp site accommodation shall be fitted with required electrical fittings lights, switches, smoke detectors as per PDO standards of 2 poles / 4 poles as per requirements. <ul style="list-style-type: none"> Lights shall be LED Type- Brand Majelite Switches and Sockets – Schneider Distribution Boards - Schneider Fire System – Conventional Type – Bristol UK 	
13. All the offices and rooms on the camp shall be supplied with Addressable smoke detectors and connected to an Addressable Fire Alarm control panel - The Panel must have one that complies with the European standards or NFPA certification for US and Canadian products. External Fire alarm shall be installed on each camp, a number of alarms depend on the Alarms strength, to ensure the coverage of all camps. All plugs and receptacles need proper marking on all fire systems, All external cables should be installed on the cable tray with plug and receptacles using the outdoor cable.	
14. All camp cabins shall be fitted with split A/C of Carrier make of 220V, 50 Hz. All Acs should have proper secondary retention	
15. All cabins shall be fitted with stairs and handrails, wherever the door is fitted. Foldable type will be preferable Stairs shell	

be designed to be easy installed and removed while moving the cabins.	
16. All Doors has to be equipped with hydraulic closer –Brand Union and secondary stop.	
17. All cabins shall be supplied with the furnishing as per contract scope of work.	
18. All the rooms shall be fitted with room heaters. (As an optional Vender has to provide solar heater) This can be avoid by Dual Type AC- Hot and Cold Option.	
19. All the lights in the camp (outside & Inside the cabins will be LED lights only. Brand Majelite. All lights should have a secondary retention	
20. Centralized fire alarm system shall be provided. Alarm has to be located in proper place to be audible. Master station location will be decided later on before drawing approval. (Main Camp / Mini Camp) - Bristol Make	
21. The Generator Room for accommodating the 2 generators shall be fabricated with roof. The roof shall be removable type and shall be nut bolted. All required doors and ventilation will be provided. Abraj to supply the 2 Generators to vender yard.	
I. Two generators with same capacity in a noiseless generator house from Caterpillar.	
II. Maintenance free Batteries will be placed in a ventilated fiberglass box.	
III. All the three phase circuit will have the 4-pole breaker & 1-phase circuit will have two pole breaker	
IV. Fire alarm system will be there inside the generator house with one alarm outside the generator house	
V. Main Panel Board. All cables should installed with proper plugs and receptacles Direct conection is not accepted. And need to install shade to protect it. Spare Plugs and receptacles in main panel shall provided for any future accessories	
VI. Cable for Termination from Generator to Main Panel Board	
VII. Cable from Main Panel Board to Skid Panel Board. All cables should installed with proper plugs and receptacles Direct connection is not accepted	
VIII. Cable from Skid Panel to Cabins DBs	
IX. Earthling Cabling	
22. Two RO plants shall be supplied and fitted in the mess (main camp) and the tea room at site. Brand Aqua Pro Capacity 150 GPM. Minimum of two sets of filters to be provide for each RO plant	
23. Each cabin / Skid shall be provided with minimum of two fire extinguisher brackets as required. Inspected date should be not more than one month before camp delivery	
24. Ladder with cage on each master skid shall be provided to reach the cabin roof top.	

25. Glass Reinforced Plastic (GRP) flooring shall be provided in the ablution and laundry areas. The GRP flooring shall be durable, non-slip, water-resistant, and resistant to chemicals commonly found in these environments to ensure safety, hygiene, and longevity.	
26. Water heaters supplied shall be AO Smith with Glass Lined if central heater provided.	
27. Water tank (GRP/ Fiberglass Water Tank Rectangular Shape with Double Skin Insulated with Capacity 30 M3 each at single skid. These water tank shall be coupled with Booster Water Pumps, Brand Grundfose Model BOOSTER PUMP SET. NO steel pipes to be used, TECHNO pipes are approved.	
28. Duty: 14CMH @ 40M No. of Pumps: 2 (1 DTY + 1 Assist) 3X415V, 50Hz, 3.2 KW, motor and a 1 No UL Listed Fire Pump which is also connected to both tanks with a Capacity 350 GPM @7 Bar- Diesel and electrical Driven) provided for the main camp shall be cylindrical with shade fitted One is sufficient which is interconnected to both tanks operated both by diesel and electrical with 50 M fire hose and nozzle. The Fire Pumps are capable of producing 1300 LPM at 10 bar pressure. (Optional Quote)	
29. Site camp shall be supplied with cylindrical water tank, water tank shall be with shade fitted with proper water pump to feed all other skids and shall also feed fire pumps which must operate both by diesel and electrical with 50 M fire hose and nozzle. The Fire Pumps are capable of producing 650 LPM at 6 bar pressure. also the tanks should have proper drain valve with ZERO dead volume. The tanks should have provision to supply the water to mud tanks (emergency shower)	
30. The camps shall be meet the requirement of ministry of man power for summer mitigation – Water Cooling System shall be provided in this regard.	
31. The diesel tank skid mounted shall be cylindrical fitted with a fuel pump. Size of Diesel Tank 25 m3	
32. Diesel tank has to be double skin with secondary containment to contain any spill. 110% Containment Facility with Flame arrestor and fuel transfer Pump along with metering device.	
33. Diesel tank has to be equipped with breather and tube level indicator. Tube level indicator should be fitted with automatic drain valves installed to prevent a spill. Ball valve is not accepted	
34. Water line with quick fix coupler Cam Lock Arrangement for the site camp	
35. Sewage line 4 inch green hose with bower couplers, estimated length of 50 m.	
36. Industrial Washing Machines – WD100, Make – IPSO Brand Speed Queen Model LWN311SP301 NW22 .must be energy-rated (minimum 4-star energy label or equivalent).	
37. Industrial Driers – DR25, Make - IPSO Brand Speed Queen Model LES17AWF	

38. All works shall be carried in accordance to PDO requirements.	
39. All built drawings shall be submitted on completion of works.	
40. The site camp stores shall be supplied with heavy duty store shelving / racks (if required).	
41. All TVs in the rooms shall be LED TVs. Brand Sony Preferred LG/Samsung 4k smart Android latest version model 2021	
<p>42. Base Frame Flooring System The base frame and flooring system for all camp units shall be designed for strength, stability, and long-term durability, suitable for frequent relocation and operation in harsh desert environments. The system shall include the following components:</p> <p>i. Base Frame Construction:</p> <ul style="list-style-type: none"> • Heavy-duty perimeter frame constructed from 100 mm x 100 mm box steel tubing, fully welded. • Intermediate joists of 50 mm x 100 mm box steel, spaced at 610 mm center-to-center, with bracing/birding for load distribution. • All steel components to be sandblasted to Sa 2.5 and coated with a 3-coat epoxy system: • Epoxy primer: 25 microns • High-build epoxy: 150 microns • Polyurethane topcoat: 50 microns <p>ii. Decking and Flooring:</p> <ul style="list-style-type: none"> • 18 mm Marine-grade plywood securely nut-bolted to the steel joists using lock nuts for vibration resistance. • Plywood undersides to be coated with coal tar epoxy for protection against moisture, rust, and termite infestation. <p>iii. Top Floor Finish:</p> <ul style="list-style-type: none"> • Heavy-duty commercial-grade vinyl sheet flooring (Brand: Duraflor or equivalent). • Specifications: Thickness: 1.5 mm minimum Type: Heterogeneous, anti-slip, sound-deadening Finish: Seamless with welded joints for hygiene and water resistance Vinyl to be heat-welded at seams and coving applied at wall junctions to allow easy cleaning <p>iv. Floor Load Rating The entire floor system shall be designed to withstand a uniform distributed load of at least 250 kg/m².</p>	
43. Grade Walls: All camp units shall be constructed with robust, thermally insulated grade wall systems to ensure structural integrity, sound insulation, and climate resilience. The wall design shall meet international standards for modular accommodation in extreme environments. The wall	

<p>system shall consist of the following components:</p> <p>i. Structural Framework: Corner posts: Double 50 mm x 100 mm steel box sections Intermediate columns: 50 mm x 100 mm steel box columns positioned at roof lifting points and wall intersections All steel elements to be fully welded, sandblasted to Sa 2.5, and coated with a 3-coat epoxy paint system (primer, high-build epoxy, polyurethane topcoat)</p> <p>ii. External Wall Panel: Cladding: 2.7 mm corrugated steel sheets with full welded seams for superior wind resistance and structural rigidity External finish: Powder-coated or epoxy-painted in weather-resistant white or client-approved color</p> <p>iii. Internal Wall Finish: 64 mm thick white PVC paneling for a clean, hygienic, and easy-to-maintain surface Insulation: High-density rock wool core (min. 50 mm thick) for thermal and acoustic performance</p> <p>iv. Trim and Seals: All interior wall connections to be sealed with PVC U-channel base trim, mechanically anchored to the floor structure Corner and edge junctions to be finished with matching PVC or aluminum trims for aesthetic and structural closure</p> <p>v. Wall Performance Standards: Fire Resistance: Rock wool insulation to be non-combustible (Class A1) Soundproofing: Internal noise isolation of up to 45 dB(A) Thermal Performance: Designed to reduce heat gain/loss in ambient temperatures between 15°C and 55°C</p>	
<p>44. Door Exterior, External doors are insulated with PU injected foam and clad with 6 mm plastic laminate faced plywood internally and 0.6 mm plastisol coated galvanized sheet externally. An aluminum channel is secured around the door blade as to ensure protection. External doors frames are manufactured from folded 3 mm thick steel plate by folding into a Z shape and fixed with a rubber sealing system. The door furniture is heavy duty freezer type with 3 no chrome plated hinges – two up high and one at the bottom. Each external door is fitted with an internal handle, a large HD rubber restrainer (350 x 110 x 10 mm reinforced rubber. no spring type restrainer allowed) and a hold open devise. All emergency doors at the ends of the corridors are fitted internally with H.D St. steel panic bar handles. Internal doors are semi solid core doors with a PU foam insulation faced with 4 mm plastic laminate faced plywood on both sides. An aluminum capping is used to protect the edge. Internal corridor doors are fitted with a vision panel 500 x 300 mm. Internal door are fitted with frame for station bill.</p>	
<p>45. Door Interior:</p> <p>i. 30"x80" standard size for interior door, Bath and toilet shall be 24" x 80"</p> <p>ii. Doors are prefinished hardboard with honeycomb</p>	

core. Equipped with cylindrical lockset and privacy lock set	
46.Windows where needed: <ol style="list-style-type: none"> UPVC framed, 6mm double glazed horizontal sliding, 900mm x 1000mm All shall be weather sealed and provided with removable insect screen 	
47. Chinese Brands will not be acceptable - if supplier deviating from above required brands approval shall be take by company during tendering phase	
48. Dual Water Chiller to be installed in each Water tank	
49. Bidder to share the option to have Solar Ligting outside the main & rig camp.	
50. Approvals Requirements: <ol style="list-style-type: none"> Obtain OPAL Approvals. Drawings to be approved by Ministry of Health (MOH). Obtain Camp approval by Civil of Defense and ambulance authority. Obtain Clinic approval by MOH . 	
51. Bidder shall Provide a Photcell sensors for the camp lights .	
52. Bidder shall provide blasting proof test	
A.2 Kitchen and Dining Hall	Compliance Yes/No?
a) The Kitchen cabin and the Dining hall cabins shall be fabricated as per details of approved drawings by Abraj.	
b) The Kitchen cabins shall be fabricated using mild steel (MS) profile sheets of 3 mm conforming to IS 2062 Grade E250 or equivalent international standards.	
c) Steel structure after sweep clean shall be coated with Epoxy primer and top coat Polyurethane epoxy paint system, white.	
d) The internal of the kitchen cabin shall be insulated with rock wool of 50 mm thick and top plywood finish of 12mm thick with 0.7mm thick Aluminum sheet. The areas were the cooking range shall be fitted with 0.5mmthick SS plain sheet. Inside the Kitchen preferred to provide SS Lining in all areas which is on 12 mm Marine Plywood. Space between cooking range & wall.	
e) The internal of the Dining hall shall be insulated with 50 MM thick rock wool insulation and with 9 mm thick MR (Moisture Resistant MDF finish)	
f) The cabin flooring will be of 18mm Marine plywood, the underneath plywood will be painted with coal tar epoxy to avoid rusting and soaking. If Marine Plywood these coal tar epoxy application can be eliminated	
g) The cabin floor of 18 mm marine plywood will be nut bolted with the main bottom angle frames to ensure the flooring is firm and does not come out during camp	

A.2 Kitchen and Dining Hall	Compliance Yes/No?
moves. 10 MM SS Bolt with Nyloc Bolt	
h) In kitchen on top of the 18 mm thick Marine ply wood an Aluminum checker plate of 4 mm thick shall be secured and all around the skirting of the kitchen cabins shall have the aluminum 4 inch skirting welded with the main plate of the flooring.	
i) The Dining hall internal floor finish will have PVC lino of 2.5 mm thick of grey color and shall be pasted with the main flooring. Please refer to above vinyl sheet specifications	
j) The cabins shall be fitted with required electrical fittings, lights, switches, smoke detectors supplied with battery operated, as per PDO standards of 2 pole / 4 pole as per requirements. Please refer to above lighting specifications	
k) Aluminum chequer plate flooring shall be provided in the kitchen.	
l) The cabins shall be fitted with 2 Ton Carrier split A/C of 220 V, 50Hz. 1.5 Ton for Accommodation and 2 Ton for Kitchen and Laundry	
m) All the cabins shall be fitted with stairs and handrails wherever the door is fitted.	
n) The kitchen and the dining hall should be fitted with freezer type doors and locks with fly mesh doors	
o) RO plant of 250 gallons shall be supplied and fitted in the mess. Brand Aquapro. Minimum of two sets of filters to be provide for each RO plant	
p) The cabins shall be provided with fire extinguisher brackets as required.	
q) The kitchen cabins shall be fitted with the equipment as shown in the attached furnishing list.	
r) The dining hall shall be fitted with the required furnishing as shown in the attached furnishing list. Water heaters supplied shall be AO Smith make.	
s) Skid Panel board suitable for these units shall be provided as shown in the sketch with cable from skid panel to the cabin isolators	
t) stainless steel shall be SS 316 L	

A.3 Electrical	Compliance Yes/No?
a) Design electrical systems strictly in accordance with IECEx and ATEX standards	
b) Change over switch / panel / sub panel / DB and 5 core rubber cable from generator room to each skid will be provided. Estimated distance of 50 meters.	
c) Need to supply cable tray or cable boom to Run securely the cables between skids.	
d) 220V/415V 3-phase power distribution board (Schneider or equivalent) with RCD protection.	
e) System (UPS 5KVA, and minimum 30 minutes) and Power Conditioner.	
f) Smoke Detector, Dicon / BRK/Eq. (1Nos)	
g) Use marine-grade, fire-resistant, low-smoke zero-halogen (LSZH) cables rated for 220 V, 60/50 Hz supply	
h) The main cable shall be fixed on cable tray under the skid up to GEN DP and disconnected by plugs and receptacle between each skids.	
i) Provide LED lighting fixtures with high ingress protection (minimum IP66) and corrosion-resistant housing (marine-grade stainless steel or powder-coated aluminum). (outside & Inside the cabins will be LED lights only. Global Axis, or any other brand with at least one year warranty.	
j) Fire alarm system will be there inside the generator house with one alarm outside the generator house	
k) Main Panel Board	
l) Cable for Termination from Generator to Main Panel Board	
m) Cable from Main Panel Board to Skid Panel Board	
n) Cable from Skid Panel to Cabins DBs.	
o) Earthing Cabling.	
p) Change over panel in case company use government electrical supply	
q) Skid Panel board suitable for these units shall be provided as shown in the sketch with cable from skid panel to the cabin isolators.	
r) Cabling from skid panel board should be armored 16 Sq.mm and 2 core to cabin.	
s) Cabling from generator panel board to skid panel board should be 25 Sq.mm, 5 core and rubber flexible cable.	
t) Loop earthing cable should be 70 Sq.mm and 5 core.	
u) Main panel board should be in generator room with socket for all outgoing cables, one extra receptacles with plug for sewage unit (63 Amps - 5 pin 3PH, N, and Ground).	
v) Isolators provided outside each cabin.	
w) All MCCBs, CBs should be either 2 Pole or 4 Pole. Schneider	
x) Bidder shall follow IEC 60446 with respect to cable colours.	
y) Current IEC 60446	
z) Protective Earth Green/yellow bi-colour	

A.3 Electrical	Compliance Yes/No?
aa) Neutral (N) Blue	
bb) Single phase: Live (L)	
cc) Three phase: L1 Brown	
dd) Three phase: L2 Black	
ee) Three phase: L3 Grey	
ff) Bidder shall Supply Abraj with copies of all design calculations, sketches, drawings, approvals from statutory authorities as applicable	
gg) Secondary retention to be installed in all floodlights to prevent floodlight from becoming a dropping hazard.	
hh) Secondary retention to be installed for all fridges and water heaters.	
1. Equipotential earth bonding to be installed from the light body and then to the structure to maintain a low impedance path to earth.	
2. IP66 rated equipment must be installed where water ingress/condensation can occur.	
3. Distribution board schedule must be installed to indicate the function of all circuit breakers & fuse rating in order to correctly identify circuits during safe isolation.	
4. All distribution boards must be locked at all times to prevent access to unauthorized personnel.	
5. Emergency strip lights with battery back up to be installed in the generator house to operate during a power failure.	
6. All emergency lights should be 'hard-wired' into a fused spur, to ensure they are not accidentally switched off.	
7. All plugs and sockets to be 3 pin for earthing purposes.	
8. Install cable glands to all junction boxes which should be IP65 rated which will prevent the accidental touching and prevent dust and water ingress.	
9. Equipotential earth bonding from equipment body to structure must be 25mm earth cable.	
10. All equipment used should be rated for 55C ambient temperatures.	
11. Portable equipment for general use is suitable for operation and of industrial construction type with plugs and sockets complying with IEC 60309.	
12. The welding workshop should contain all necessary safety and earthing devices.	
13. All A/Cs to be split type and rated for 55C.	
14. As a minimum the electrical installations of the camp shall comply with IEC 60364 (all parts) or the IET Wiring Regulations BS 7671.	
15. The system shall be designed such that plant items and equipment can be safely isolated from electrical power sources during preventative and unplanned maintenance and that the adjustment and testing of live equipment can be carried out safely. Emergency stop switches / push buttons for MCCB /	

A.3 Electrical	Compliance Yes/No?
ACBs (moulded case circuit breaker / Air circuit breaker) shall be located in strategic locations.	
16. Documentation of system capacities for normal conditions, short circuit and motor starting, equipment ratings and impedances, wiring configurations and earthing arrangements.	
17. Bidder to ensure that all outer and inner panels to be properly sealed to prevent intrusion of sand during sand storms.	
18. All portable equipment is tested by the supplier and the test certificate shall be available for inspection.	
19. Portable equipment for general use is suitable for operation and of industrial construction type with plugs and sockets complying with IEC 60309.	
20. Mains voltage equipment is to be supplied where it is not practicable to use RLV equipment and should be of double insulated construction.	
21. All circuits for portable equipment should have a RCD installed either at the distribution board which feeds the mains supply sockets or at the fixed mains supply socket. In either of these positions they shall provide protection for both cable and tool.	
22. Bidder to consider reducing the risk of damage of flexible supply leads by adopting the following:	
23. positioning them where they are less likely to be damaged, (eg run them at ceiling height inside a building); and/or	
24. protecting them inside impact resistant conduit where appropriate; or	
25. Using special abrasion resistant or armored flexible supply leads where appropriate.	
26. Use of multiway extension cables and socket adapters shall be in compliance with BS 1363, IEC IECEE CEE-7 or IEC 60309.	
27. Bidder shall display safety warning signs on all electrical equipment stating the voltage level; such signs shall be displayed in English and Arabic as a minimum.	
28. Plugs, sockets, outlets and couplers shall conform to IEC 60309 and shall be coloured coded as described in the standard (reference IEC 60309 7.7 Table 2)	
29. All socket outlets except those for RLV or SELV (Safety Extra Low Voltage) systems shall be protected by RCD.	
30. Sockets for domestic use in accommodation and offices shall comply with BS 1363 or IEC IECEE CEE-7 with protective earth installed.	
31. All equipment used shall be constructed to the appropriate National Standards. It shall be robust and have an IP rating suitable for the environment in which it will be used in accordance with IEC 60529. For external equipment the minimum rating is IP 54 (Dust / Splashing). A sunshade cover should be erected over any external Main Distribution Units (MDU). Bathroom electrical fixtures and fittings shall be rated minimum IPX4.	

A.3 Electrical	Compliance Yes/No?
32. All non-portable equipment shall be securely fixed unless it is designed to be free standing. It should be sited allowing adequate access for maintenance purposes.	
33. If the source is an ACB or an MCCB, the incoming device should be a fuse switch suitably rated for interrupting the expected fault current.	
34. Distribution of power shall be in accordance with BS 7375.	
35. All cables used in office / accommodation that are likely to be frequently relocated in normal use shall be flexible, color coded and of heavy duty neoprene rubber type or equivalent.	
36. Fixed cables on systems shall also be as per the industry standards (e.g. single wire armour type to BS 5467 or BS 6724 or steel braided type to BS 6883 or BS 7919). Cables in compliance with an equivalent international standard are acceptable. Bidder to provide proof that the mentioned standards are followed.	
37. Trailing cables, including extension cables, should never be used with any length of cable left wound on the drum.	
38. Cables shall be sized for thermal effects and voltage drop depending on the installation conditions to meet the requirements of the IET Wiring Regulations.	
39. Isolators provided outside each cabin.	
40. All MCCBs, CBs should be either 2 Pole or 4 Pole.	
41. Secondary retention to be installed in all floodlights to prevent floodlight from becoming a dropping hazard.	
42. Equipotential earth bonding to be installed from the light body and then to the structure to maintain a low impedance path to earth.	
43. IP66 rated equipment must be installed where water ingress/condensation can occur.	
44. Distribution board schedule must be installed to indicate the function of all circuit breakers & fuse rating in order to correctly identify circuits during safe isolation.	
45. All distribution boards must be locked at all times to prevent access to unauthorised personnel.	
46. Emergency strip lights with battery back up to be installed in the generator house to operate during a power failure.	
47. All emergency lights should be 'hard-wired' into a fused spur, to ensure they are not accidentally switched off.	
48. All plugs and sockets to be 3 pin for earthing purposes.	
49. Install cable glands to all junction boxes which should be IP65 rated which will prevent the accidental touching and prevent dust and water ingress.	
50. Equipotential earth bonding from equipment body to structure must be 25mm earth cable.	
51. Generator containers big enough to house two numbers of caterpillars generators along with distribution panel for each camp and rig site and both DP panel sides shall be accessible with enough space to install extra receptacles and sockets	

A.3 Electrical	Compliance Yes/No?
when needed.	
52. Installation of generators in the generator house and carrying out all electrical connections from the generator to the distribution panel and from the distribution panel to each individual cabin.	
53. Earthing Cable should run directly without interconnection from Individual cabin panel to the main skid distribution panel.	
54. Electrical Signal line diagram, showing all sources of electrical power, system interconnections, system loads.	
55. Additional plastic cable tray trunking in office as per customer needs.	
56. Bidder should provide cable boom between each cabin with cable connections.	

A.4 Reference standards	Compliance Yes/No?
a) (BS 1363) - 13 A plugs, socket-outlets, adaptors and connection units b) (BS 4363: 1998) - Distribution Assemblies for Reduced Low Voltage Electricity Supplies for Construction and Building Sites c) (BS 5467: 1997) - Electric cables Thermosetting insulated, armoured cables for voltages of 600/1000 V and 1900/3300 V d) (BS 6724) - Electric cables – Thermosetting insulated, armoured cables for voltages of 600/1000 V and 1900/3300 V, having low emission of smoke and corrosive gases when affected by fire e) (BS 7919:2001) - Electric cables – Flexible cables rated up to 450/750V, for use with appliances and equipment intended for industrial and similar environments f) (IEC IECCEE CEE-7) - Specification for plugs and sockets outlets for domestic and similar purposes g) (IEC 60309-1&2: 1999) - Plugs, Socket-Outlets and Couplers for Industrial Purposes - Parts 1 & 2 h) (IEC 60364) - Low-voltage electrical installations (All parts) i) (IEC 60529: 1992) - Degrees of protection provided by enclosures (IP Code)	

A.5 Drawings / Documentation Requirements (Auto Cad, PDF)	Compliance Yes/No?
a) Camp lay out with skids	
b) Rig lay out with skids	
c) Individual drawings of each skid with included furniture and Bill of Material.	
d) Water Piping lay out	

A.5 Drawings / Documentation Requirements (Auto Cad, PDF)	Compliance Yes/No?
e) Sewage piping layout.	
f) Lifting point register	
g) Certificate for conformance for all skids / cabins and equipment provided.	
h) Layout diagram, clearly showing location, transformers, distribution unit, switchgear and load centers including the distances between them and the cable routes wherever applicable.	
i) Data book for each skid which includes drawings, furniture details, sources of supply, testing requirements, etc.	
j) List of all suppliers/subcontractors.	
k) Parts list and operation / service manuals for all equipment supplied with the camp.	
l) Pad eye register.	
Note 1: The Bidder shall provide the complete set of Certification and Documentation including Manufacturer's record book also called as Data book within 15 days from the delivery of the Equipment. The Seller shall provide 3 set of all certificates and documents in Original to Project In charge.	
Note 2: Bidder shall provide the Drawing before issuing the PO for approval and review.	

A.6 Camp Move	Compliance Yes/No?
a) All cabins should be designed for easy camp move, all furniture including PCs, printers, book shelves, etc. should be fixed	
b) Electrical Cable shall be designed to eliminate difficult handling (the minimum allowable cable length between receptacles and plus is 15 meter)	

A.7 Others	Compliance Yes/No?
a) Contractor shall provide all technical resource required for Camp spot and test at field.	
b) Each camp and rig site units shall be completely furnished as per approved drawings.	
c) Vender shall provide AutoCAD layout with accurate measurement after final spot of main / minicamp.	
d) 15 years minimum, high quality construction and features, with a minimum 10 years warranty to be given by the manufacturer for the building construction. Equipment supplied & installed by the manufacturer shall be provided with no less than 12 months warranty from final site commissioning of the	

buildings.	
e) Bidder shall follow Abraj Material Specification in Appendix 3	

A.8 Delivery Schedule required by Abraj, but no later than the following.	Compliance Yes/No?
8 weeks from purchase order released	

A.9 General Notes	Compliance Yes/No?
a) All surfaces where paint is to be conducted shall be free from contamination.	
b) Airless spray guns shall be used for conducting painting jobs. In case of small areas or areas hard to reach, a brush can be used but care is to be taken to achieve the specified DFT.	
c) The surface shall dry up properly after a high-pressure cleaning job. Excessive moisture can make the paint look patchy in appearance.	
d) For the painting to be proper, suitable drying time shall be allowed after each coat as mentioned in the specifications.	
e) For all external painting, the final coat shall always be Glossy.	
f) Only JOTUN paint shall be used unless Abraj specified otherwise.	
g) Bidder shall supply all PPE requirements for his crew.	
h) Bidder shall comply to submit weekly progress dashboard once the contract is awarded.	
i) The Bidder shall comply with the paint specification codes listed in Appendix 4. Any superior industrial alternative may be proposed, subject to Abraj's approval.	
j) Bidder shall submit weekly progress updates.	
k) Bidder complies with Abraj HSE policy for on-site work and is responsible for providing PPE for their crew.	

Appendix 1:

Main Camp - (Rig)				
Skid #	Qty	Cabin	Description	Remarks
1	6	1A	Junior Staff Room	Two Bed Room
		1B	Junior Staff Room	Two Bed Room
		2A	Junior Staff Room	Two Bed Room
		2B	Junior Staff Room	Two Bed Room
		3A	Junior Staff Room	Two Bed Room
		3B	Junior Staff Room	Two Bed Room
		4A	Senior Staff Room	One Bed Room
		4B	Senior Staff Room	One Bed Room
2	1	1A	R/O Office	
		1B	Medic Room	
		1C	R/O Room	
		1D	Medic Waste Room	
		1E	Clinic	As per approved drawing from MOH
3	1	1	Mess Hall # 1	Both the mess hall shall be interconnected
		2	Mess Hall # 2	Both the mess hall shall be interconnected
		3	Kitchen	
4	1	1	Chiller	
		2A	Dry Store 1	
		2B	Dry Store 2	
		3A	Laundry	
		3B	Chemical Store	
		3C	CampBoss Office	
5	1	1	Laundry	
		2A	Chemical Store	
		2B	Paryer Room	
		3A	Ablution	
		3B	Water Tank	Capacity 30 m3
		3C	Fire pump	
6	1	1A	Prayer Room	
		1B	Ablution	
7	1	1A	Water Tank + Fire pump	Capacity 35 m3
8	1	1A	TV Recreation #1	
		1B	TV Recreation #1	
		2A	Gym	
		2B	Library	
9	1	1A	Diesel Tank	Capacity 25 m3

		1B	Power Room	
Mini Camp				
Skid #	Qty	Cabin	Description	Remarks
1	1	1A	Meeting Room & Primary Security cabin	
		1B	H2S + SCBA Store	
		2A	Training Room	
		2B	Library	
		3A	Bulk storage room	
		3B	Conference room	
2	1	1A	Store	
		1B	Office	
		1C	Mechanical store	
		1D	Electrical store	
		1E	Rubber store	
		Out	Sling Store	
		Out	Paint Store	
		2A	Wash Area+ Ablution	
		2B	Toilet	
		3	Tea Room	
3	1	1	Prayer Room	
4	1	1	Work Shop	With full accessories
		2A	Chief Mechanic office	As per layout provided
		2B	Chief Mechanic Store	As per layout provided
		3A	Chief Electrician office	As per layout provided
		3C	Chief Electrician Store	As per layout provided
5	1	2B	Water Tank + Water pump-cooling pump-fire pump	
6	1	1A	Tool pusher office	
		1B	R/O + Medic office	
		2A	DSV Office	
		2B	Small Toilet	
		3A	Mud Lab	
		3B	Assistant DSV office	
7	1	1A	Senior Staff Room	One Bed Room
		1B	Senior Staff Room	One Bed Room
		2A	Senior Staff Room	One Bed Room
		2B	Senior Staff Room	One Bed Room
		3A	Senior Staff Room	One Bed Room
		3B	Senior Staff Room	One Bed Room

B. Bidder Compliance

		4A	Senior Staff Room	Two Bed Room
		4B	Senior Staff Room	Two Bed Room
8	1	1A	Secondary Cabin Point	
9	1	1A	Welding Work Shop	
		1B	Steel/Pipe storage area	
10	1	1B	Client Store	
		1C	Client Store	
11	1	1A	Waste skip	

Company Requirements	Compliance (Yes / No)
1. Commitment to close all observations (100%) during FAT/Commissioning prior to final acceptance and delivery of the system.	
2. All Welders performing welding jobs shall be certified, as per standard requirement of API and their welding certificate shall be submitted along with bid submission	
3. Design electrical systems strictly in accordance with IECEx and ATEX standards	
4. The mobile camp shall be designed and constructed in accordance with the standards and specifications: SP-1110 Specification for Electrical Supplies to Mobile Camp SP-1277 Transportable Accommodation Units OPAL Standard	
5. Commitment to deploy only skilled and experienced personnel on job, especially Electricians; the company reserves the right to audit and interview personnel engaged in the project and terminate the contract if bidder fails to maintain its commitment	
6. Bidder Commitment to deliver each camp in line with the Scope of Work within 8 weeks of the date of receipt of the PO.	
7. Bidder shall commit to providing a minimum of 12 month's warranty from the date of use of Camp accessories and 10 years for the structure.	
8. Bidder shall have experience with Abraj or any other drilling companies in Oman in the fabrication of at least 3 camps, and 5 years of industry experience in MOH and building Camps.	

C. Bidder Deviations (If Any)

Additional Info:

- Contract Duration: 2+1 Year.

Bidder Submitted Specification

Bidder Deviations (If Any)

Main Camp Layout

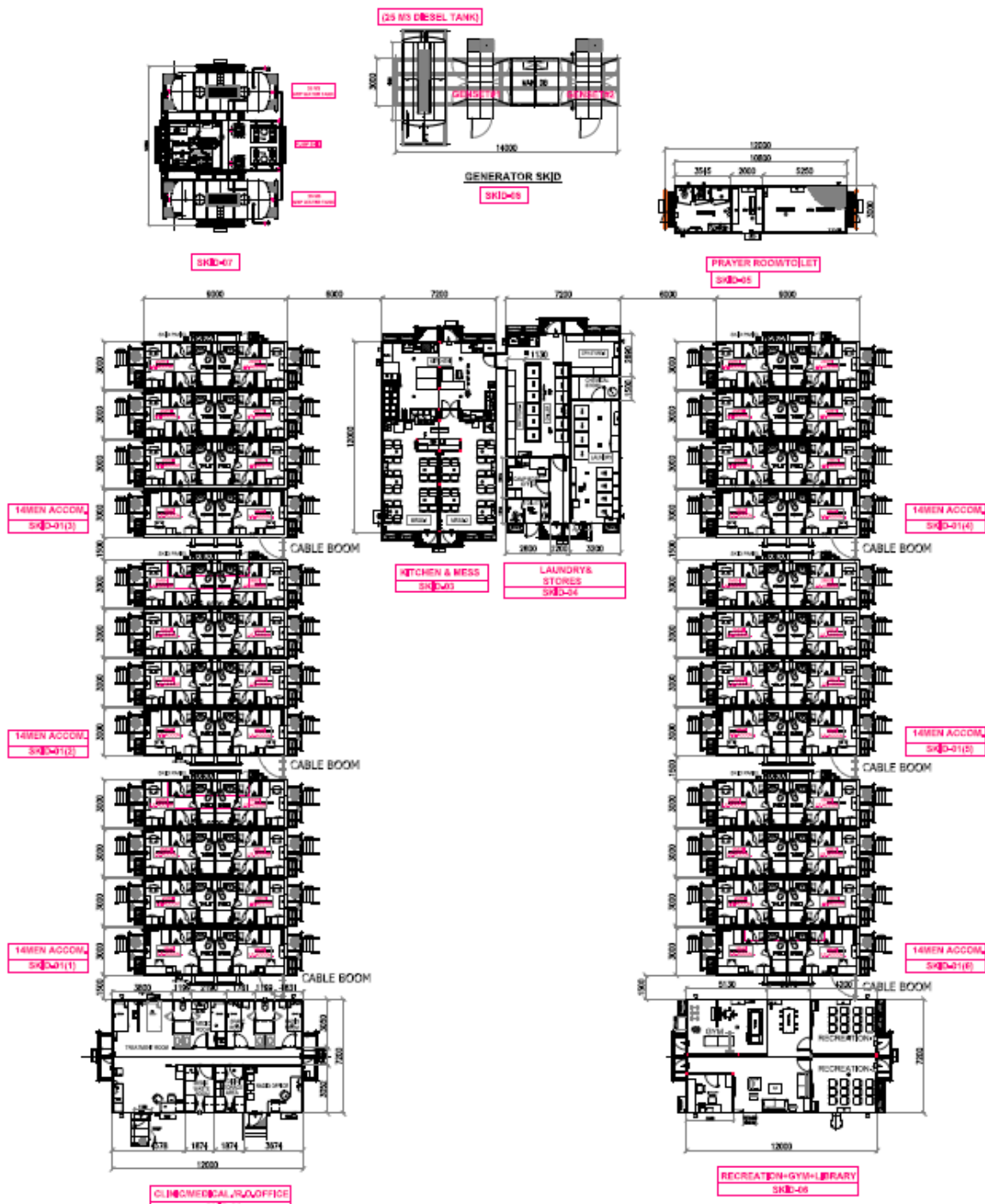

Mini Camp Layout

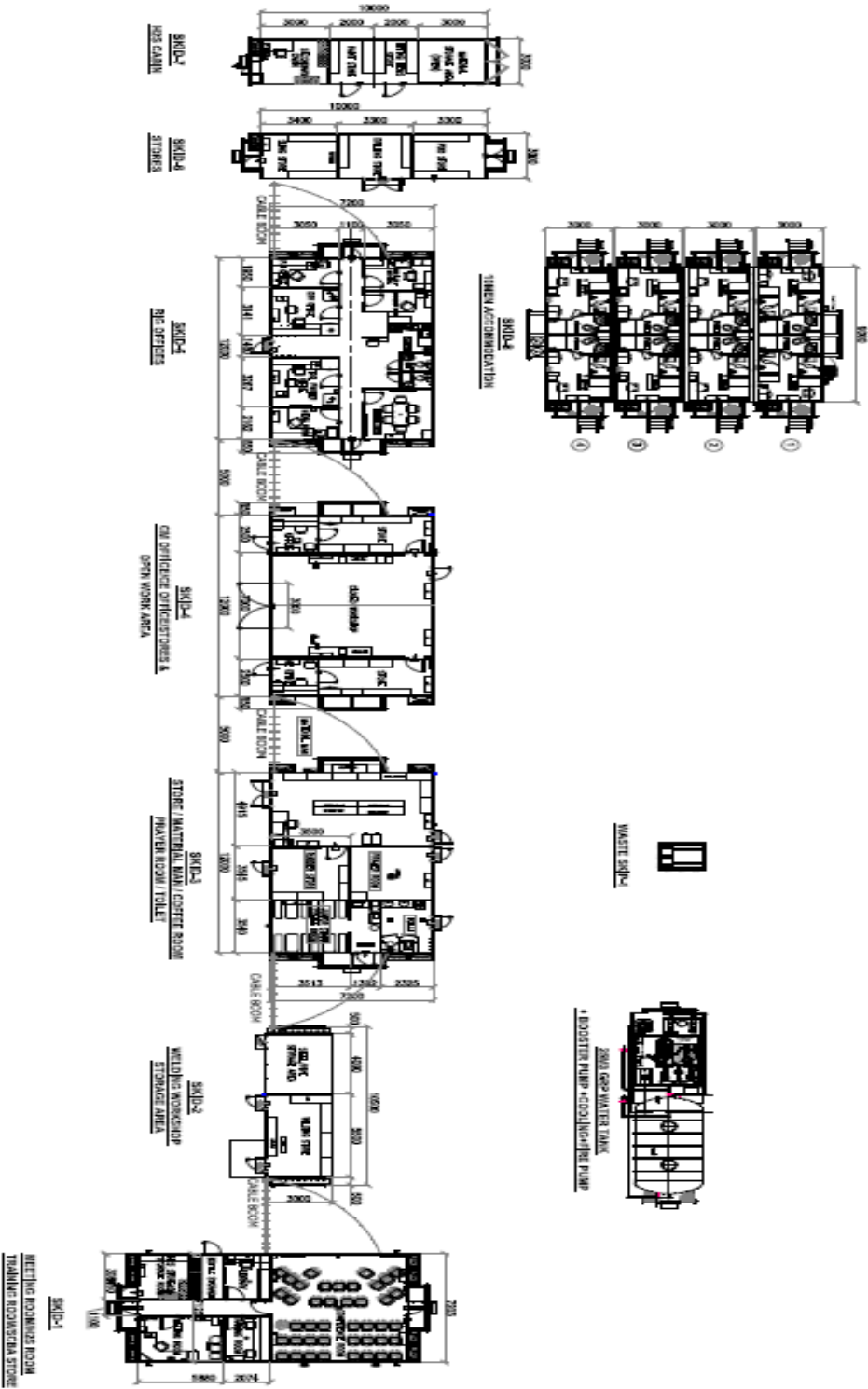

Appendix 3:
Material Specification List

Materials- Rig Mini Camp

Sl No	Item	Dimension/Specifications	Brand	Remarks
1	Bed - Single Bed Built In	900 X 2000 Mm	Best available in Market*	Permanent Fix
2	Semi Medical Mattress	900 X 2000 X140 Mm	Raha	
3	Quilt - Comforter	900 X 2000 Mm	Raha	
4	Quilt Cover		Best available in Market*	
5	Bed Sheet	900 X 2000 Mm	Best available in Market*	2 No Per Bed
6	Pillow		Raha	2 No Per Bed
7	Pillow Case		Best available in Market*	2 No Per Bed
8	Hand towel	50x70 Cm	Best available in Market*	2 No Per Bed
9	Bath towel	70x 140 Cm	Best available in Market*	2 No Per Bed
10	Desk With Cabinet On Top		Best available in Market*	Permanent Fix
11	Chair With Arm Rest		Canary	
12	Ms Powder Coated Shoe Rack	860x600x2430	Canary	
13	Mirror Above Washbasin	600 X 450	Best available in Market*	
14	Water Closet- Wall Hung With Smooth Close Cover		Laufen	Switzerland
15	Concealed Cistern		Grohe	Germany/Austria
16	Wash Basin- Glass Reinforced (Grp)	735x515		Grp
17	Toilet - Grp Cubicle Offshore Type- Double Door	1260 X 2110	Best available in Market*	Grp Cubicle- Offshore Type
18	Bed Assisted Book Shelf		Best available in Market*	
19	Shower Mixer		Grohe	Germany/Austria

	With Soap Tray			
20	Basin Mixer With Lifting Lever		Grohe	Germany/Austria
21	Basin, Shower And Water Heater Angle Valves		Grohe	Germany/Austria
22	Shattaf Bidet Sprayer		Grohe	Germany/Austria
23	140 Liter Water Heater		Ao Smith	Ecs-40 Glass Lined
24	Oil Field Type External Door With Vision Panel		Best available in Market*	Heavy Duty Type
24	Freezer Door Lock External Door		Best available in Market*	Heavy Duty Type
25	Emergency Door - Oil Field Type		Best available in Market*	Heavy Duty Type
26	Panic Bar		Union	
27	Internal Wooden Door	800 X 1950 X40 Mm	Best available in Market*	
28	Internal Door Lock-Knob Set		Union	
29	Hydraulic Door Closure- External Door Lock		Union	
30	Corridor Door With Vision Panel (500 X 300)	800 X 1950 X40 Mm	Best available in Market*	
31	Hydraulic Door Closure- Corridor		Union	
32	Toilet Door- Aluminum/Upvc	600 X 1900 Mm	Best available in Market*	
33	A4 Size Frame - Emergency Route Plan		Best available in Market*	
34	Fire Extinguisher- 9kg Abc Type		(Nafcoo & Bristol) only will be accepted	
35	Refrigerator - Bar Fridge	85 Liter	Sharp, LG	Mini Bar Type
36	Television	32"	(LG,Samsung,Sony) Smart 4K	

37	Television Stand With Corner Table		Best available in Market*	
38	Helmet Hook			
39	Air Conditioner	1 Ton Refrigeration	Carrier	Ambient Temperature - 52° C
40	Steel Cupboard - External		Canary	
41	Exhaust Fan-6"	6"	Panasonic	
42	Paper Holder		Ikea	
43	Led Room Light		Majelite	Model : Od120s-2330
44	Corridor Light		Majelite	Model : Ord1220-2000
45	Bathroom Light		Majelite	Model : Ddl170-2250
46	Bulk Head Light		Majelite	Model : W2080
47	Bed Light		Majelite	Model : Vml30-610
48	Mirror Light		Majelite	Model : Vml30-610
49	Emergency Light		Ventilux	Vinm3/F8
50	Flood Light		Majelite	Model : 400w-M/H
51	Desk Light		Majelite	Model : Vml30-610
52	Main Distribution Board		Schneider	
53	Sub Distribution Board		Schneider	
54	Switches & Sockets		Schneider	
55	2.5 Mm Single Core Stranded Wire		Nuhas Oman	
56	4 Mm Single Core Stranded Wire		Nuhas Oman	
57	4 Mm 3 Core Pvc Flexible Wire		Nuhas Oman	
58	63 A 4 Pole Isolator		Scame	
59	Flood Light Stand		Best available in Market*	

60	Washing machine		Girbru or equivalent industrial	
61	Dryer		ADC or equivalent industrial	
Rig Office Cabin- Pe Office+ Company Man+ Contractor Office+ Cm Office+ Ce Office + Medic+ Mud lab+ Coordinator + Pantry + Ablution + Meeting Room				
Coordinator + Pantry + Ablution + Meeting Room				
1	Desk (L Shape) With Acrylic Sheet	2880 X 2000		
2	Desk (L Shape) With Acrylic Sheet	3035x2090		
3	Desk (L Shape) With Acrylic Sheet	3236x2090		
4	Desk (L Shape) With Acrylic Sheet	1800x1930		
5	Desk (L Shape) With Acrylic Sheet	700x2110		
6	Desk (L Shape) With Acrylic Sheet	1880x2030		
7	Pantry Table	1400x1520		
8	Wooden Wall Cabinet	400x2880		
9	Wooden Wall Cabinet	400x2090		
10	Wooden Wall Cabinet	400x2880		
11	Wooden Wall Cabinet	400x1120	Best available in Market*	
12	Meeting Room With Table-6 Nos	1600x800x760	Best available in Market*	
13	Windoe With Protection Grill	600x800	Best available in Market*	
14	4 Tier Filing Cabinet	465x620x1320	Canary	
15	2 Tier Filing Cabinet	465x620x720	Canary	
16	Ptw Board	1500 X 1200	Best available in	

			Market*	
17	Stainless Stell Single Bowl Sink	1000x600	Xoxo	
18	Refrigerator - Westpoint 140 Liter	140 Liter	West Point Or Eq	
19	Microwave Oven- Samsung		Samsung	
20	Shelve	700x770	Best available in Market*	
21	Office Swivel Chair		Canary	
22	Deskchair Without Arm Rest		Canary	
23	White Board	900x600		
24	White Board	1500x900		
25	Helmet Hook	Helmet Hook		
26	Oil Field Type Door (2000 X 800)With Vision Panel (300x300 Mm)			
27	Oil Field Type Door			
28	Internal Door (800x1950)With Vision Panel (500x300 Mm)			
29	Sliding Door (750 X 2000 Mm)			
30	Internal Door (800x1950)	800 X 1950		
31	Wooden Cabinet	600x350x500		
32	Ss Single Bowl Sink Heavy Duty	1000 X 600	Xoxo	
33	Ss Steel Desk Table	600 X 1000		
34	Water Cooler- Oasis			
35	Pantry With Cupboard	400x700		
36	Filing Cabinet With Sliding Door	350x1950		

37	Television -42"			
38	2 Seater Sofa		Best available in Market*	
39	Water Closet - Laufen		Laufen-Swiss	
40	Wash Basin		Grp	
41	Paper Holder		Ikea	
42	Shattaf Bidet Sprayer		Grohe	
43	Toilet Door	800x2000	Best available in Market*- Upvc/ Alu	
44	Air Conditioner- 1.5 Ton	Carrier	Carrier	
45	Exhaust Fan	Panasonic	Panasonic	
46	Fire Extinguisher	Bristol- 9 Kg	Bristol	
47	A4 Size Frame For Escape Plan		Best available in Market*	
48	Flood Light With Stand		Best available in Market*	
49	Radio Mast		Best available in Market*	

Rig Workshop (Electrical Workshop + Electrical Store + Drilling Store + Mechanical Workshop Office + Mechanical Workshop+ Mechanical Store

1	Work Bench	6840x700x760	Best available in Market*	
2	Work Bench	2000x700x760	Best available in Market*	
3	Work Bench	3290x700x760	Best available in Market*	
4	Fire Extinguisher	Bristol- 9 Kg	Bristol	
5	Steel Cupboard		Canary	
6	Desk	1700x700x760	Best available in Market*	
7	Desk	2520x700x760	Best available in Market*	
8	Chair With Arm Rest		Canary	
9	Wooden Cabinet	450x700	Best available in Market*	
10	Storage Cabinet	1950x450x2322	Best available in Market*	
11	Office Swivel Chair		Canary	
12	Shelf With	2930x450	Best available in	

	Stopper		Market*	
13	Shelf With Stopper	1980x450	Best available in Market*	
14	Tool Hanger		Best available in Market*	
15	Shelf With Stopper	2260x450	Best available in Market*	
16	Shelf With Stopper	1320x450	Best available in Market*	
17	Shelf With Stopper	1810x450	Best available in Market*	
18	Shelf With Stopper	1510x450	Best available in Market*	
19	Flood Light With Stand	800x600	Best available in Market*	
20	Oil Field Door With Vision Panel	800x2000	Best available in Market*	
21	Internal Sliding Door	800x2000	Best available in Market*	
22	Shelf With Stopper	600x4000	Best available in Market*	
23	Shelf With Stopper	600x2780	Best available in Market*	
24	Air Conditioner- 1.5 Ton		Carrier	
25	Exhaust Fan- 6"		Panasonic	
26	Oil Field Type Door	800+300x2000	Best available in Market*	
27	Window With Protection Grill	800x600	Best available in Market*	
Rig Training And Conference Cabin - (Watchman+ H2s Briefing Room+Training Room+ Conference Room+Record And Library+ H2SPPrimary Room With SCBA Store)				
1	Chair With Arm Rest		Canary	
2	Office Swivel Chair		Canary	
3	Folding Seat		Canary	
4	Rack For Computer And Sound System	650x450x1200	Best available in Market*	
5	Podium	700x400x1100	1	
6	Trophy Cabinet	550x550	Best available in Market*	
7	Projector- Sony		Sony	
8	Manual Projectr-		Sony	

	Screen			
9	Desk With Acrylic Sheet	700x2880	Best available in Market*	
10	Desk L- Shape With Acrylic Sheet	500x1550	Best available in Market*	
11	Wooden Wall Cabinet	400x2880	Best available in Market*	
12	Wooden Wall Cabinet	450x2880	Best available in Market*	
13	H2s Rack-01		Best available in Market*	
14	H2s Rack-02		Best available in Market*	
15	Desk L - Shape With Acrylic Sheet	700x2880	Best available in Market*	
16	2 Tier Filing Cabinet	456x620x720	Best available in Market*	
17	Mobile Storage Box		Best available in Market*	
18	H2s Card Holder		Best available in Market*	
19	Fire Extinguisher	9 Kg Bristol	Bristol	
20	Television -32"	Sony - 32"	Sony	
21	Wooden Cabinet	400x2080	Best available in Market*	
22	Wooden Cabinet	400x980	Best available in Market*	
23	Oil Field Type Door	800x2000	Best available in Market*	
24	Oil Field Type Double Door	800+300x2000	Best available in Market*	
25	Internal Door With Vision Panel (500x300)	800x2000	Best available in Market*	
26	Internal Door	800x2000	Best available in Market*	
27	Emergency Door	800x2000	Best available in Market*	
28	Air Conditioner- 1.5 Ton	Carrier	Carrier	
29	Water Cooler- Oasis		Best available in Market*	
30	Helmet Hook		Best available in Market*	

31	Window With Protection Grill	600x800	Best available in Market*	
32	Window With Protection Grill	1200x800	Best available in Market*	
33	A4 Size Frame For Escape Plan		Best available in Market*	
34	Flag Pole- Oman		Best available in Market*	
35	Flag Pole- Abraj		Best available in Market*	
36	Windsock		Best available in Market*	
37	Flood Light With Stand		Best available in Market*	
WHSE (Material Man + Store + Rubber Store + Pantry + Ablution+ Mosque)				
1	Dining Table	1200x760x560	Best available in Market*	
2	Dining Bench	1200x330x450	Best available in Market*	
3	L Type Table With Acrylic Sheet		Best available in Market*	
4	Shelf With Stopper	1750x600	Best available in Market*	
5	Shelf With Stopper	3050x600	Best available in Market*	
6	Shelf With Stopper	2000x600	Best available in Market*	
7	Shelf With Stopper	1200x600	Best available in Market*	
8	Shelf With Stopper	1990x450	Best available in Market*	
9	Storage Cabinet	1980x450	Best available in Market*	
10	Storage Cabinet	5790x600	Best available in Market*	
11	Storage Cabinet	1810x600	Best available in Market*	
12	Storage Cabinet	4310x450	Best available in Market*	
13	Cup Board		Best available in Market*	
14	Helmet Hook		Best available in Market*	
15	Floor Carpet		Joory Brand-	

			Alexandria	
16	Wooden Cabinet		Best available in Market*	
17	Service Window		Best available in Market*	
18	Shattaf Bidet Spray		Grohe	
19	Stainless Steel Single Bowl Sink		Xoxo	
20	Notice Board		Best available in Market*	
21	Office Swivel Chair		Canary	
22	2 Tier Filing Cabinet	465x620x720	Canary	
23	Book Shelf Full Height	2670x330	Best available in Market*	
24	Condiment Rack	400x150x150	Best available in Market*	
25	Television - Sony 42"	Sony	Sony	
26	Ice Cube Machine	Brem Italy	Berma Italy	
27	Juice Dispenser	Comfimelly Italy	Comfimelly	
28	Water Boiler- Burco 30 Liter	Burco 30 Ltr Uk	Burco Uk	
29	Water Cooler Oasis	Oasis Oman	Oasis Oman	
30	Water Closet- Laufen	Laufen Swiss	Laufen- Swiss	
31	Ss Asian Squat Pan	Hd Ss Squat Pan	Ss Heavy Duty	
32	Vanity Wash Basin With Double Bowl	Grp	Best available in Market*	
33	Foot Wash Basin	Grp	Best available in Market*	
34	Oil Field Type Door With Vision Panel	2000x800 (300x300)	Best available in Market*	
35	Wooden Internal Door	2000x800	Best available in Market*	
36	Wooden Sliding Door		Best available in Market*	
37	Oil Field Type Door Without		Best available in Market*	

	Vision Panel			
38	Air Conditioner		Carrier	
39	Exhaust Fan		Panasonic	
40	Ro Plant - Aqua		Aqua Pro	
41	Paper Holder		Ikea	
42	Window With Protection Grill	800x600	Best available in Market*	
43	Window With Protection Grill	800x1200	Best available in Market*	
44	Flood Light With Stand	800x1200	Best available in Market*	
45	Fire Extinguisher	Bristol Uk	Bristol Uk	
Water Tank				
1	Water Tank-15 M3	Grp Double Lined	Best available in Market*	Grp
2	Booster Pump+ Operational Plus Standby	Booster Pump Set Duty : 5.0cmh @ 20m No. Of Pumps: 2 (1 Dty + 1 Standby) 3x415v, 60hz, 0.74 Kw, Motor	Best available in Market*	
3	Cluster Filter	Cf-10	Aqua Pro	
4	Fire Pump-350 Gpm Ul Listed Diesel+ Electric Operated		Bristol	
5	Cage Ladder		Best available in Market*	
6	Water Outlet Manifold- 5 Outlet	Ppr Pipes	Techno Pipes	
7	Shade For Water Tank Size -12 X 3 Mtr, Height 3 Mtr		Best available in Market*	
8	Skid For Water Tank- 3 Runner Skid		Best available in Market*	
9	Water Network Pipes - Ppr Pipe		Techno Pipes	
10	Drainage Network Pipes		National Plastic	
11	Cam Lock For Cabin Water Network		Best available in Market*	

	Connection			
Welding Shop				
1	Welding Area		Best available in Market*	
2	Folding Shutter		Best available in Market*	
3	Steel Rack For Storage		Best available in Market*	
4	Area For Storage		Best available in Market*	
H2S Secondary + Paint Store				
1	SCBA Storage Area		Best available in Market*	
2	Rack - Paint Storage		Best available in Market*	
3	Explosion Proof Fan		Profen	
4	Explosion Proof Light		Tht-Ex Taiwan	

*** Bidder is required to submit their preferred brand and get approved from Abraj before bid submission.**

****For kitchen equipment, Only Marino or Fagor brand will be accepted. If bidder has any proposal other than mentioned then, bidder is expected to consult and seek approval before bid submission.**

Appendix 4:

The Bidder shall comply with the paint specification codes listed in Appendix 4. Any superior industrial alternative may be proposed, subject to Abraj's approval.

Paint Specification Codes:

Based on the equipment and the surface on which the painting is to be conducted, a Paint Specification Code has been prepared. The Paint Specification Codes to be applied to different equipment based on the painting surface are listed below in the table:

PAINTING SURFACE			
New / Deeply Corroded Surface	Corrosion Developed All Along Surface	Corrosion Exists but is Deeply Corroded in Certain Areas Only	Surfaces Covered with Dirt, Oil & Grease with Minor Paint Damage
AES – PSC – 001	AES – PSC – 002	AES – PSC – 003	AES – PSC - 004

Paint Specification Code Details:

PAINT SPECIFICATION CODE - AES –PSC–001								
Painting Surface - New & Deeply Corroded Surface								
Pre-Treatment: - All areas are to be cleaned thoroughly with strong detergents and high-pressure fresh water to remove oil, grease, salt, and contaminations. All areas are to be sandblasted to SA 2.5(ISO 8501-1:1988) roughness using abrasives suitable to achieve minimum grade fine (ISO 8503-2)								
Painting								
				Minimum Recoating Intervals			Thinner	
Coat No.	Product	Area to Paint	DFT (µm)	10 deg C	23 deg C	40 deg C	No.	Max %
1	Resist 78, Grey	100%	75	13 h	4 h	1.5 h	4/25	5
2	Penguard Mid Coat, White/Red	100%	150		6 h	3 h	17	5
3	Hardtop XP, MCI, (RAL as per Paint Scheme)	100%	50	14 h	7 h	4 h	10	5

PAINT SPECIFICATION CODE - AES – PSC-003								
Painting Surface - Corrosion Exists but is Deeply Corroded in Certain Areas Only								
Pre-Treatment: - All areas are to be cleaned thoroughly with strong detergents and high-pressure fresh water to remove oil, grease, salt, and contaminations. All areas are to be swept blasted to completely remove the surface corrosion. The deeply corroded areas are to be sandblasted to SA 2.5(ISO 8501-1:1988) roughness using abrasives suitable to achieve minimum grade fine (ISO 8503-2).								
Painting								
Coat No.	Product	Area to Paint	DFT (µm)	Minimum Recoating Intervals			Thinner	
				10 deg C	23 deg C	40 deg C	No.	Max %
	Surfaces with Corrosion (Sweep Blasted areas)							
1	Jotomastic 80, Std.	100%	100	24 h	10 h	4 h	17	10
2	Hardtop XP, MCI, (RAL as per Paint Scheme)	100%	50	14 h	7 h	4 h	10	5
			150					
	Deeply Corroded Areas							
1	Jotomastic 80, Std.	100%	150	24 h	10 h	4 h	17	10
2	Hardtop XP, MCI, (RAL as per Paint Scheme)	100%	50	14 h	7 h	4 h	10	5

PAINT SPECIFICATION CODE - AES – PSC- 004								
Painting Surface - Surfaces covered with dirt, oil & grease with minor paint damage								
Pre-Treatment: - All areas are to be cleaned thoroughly with strong detergents and high-pressure fresh water to remove oil, grease, salt, and contaminations.								
Coat No.	Product	Area to Paint	DFT (µm)	Minimum Recoating Intervals			Thinner	
				10 deg C	23 deg C	40 deg C	No.	Max %
1	Hardtop XP, MCI, (RAL as per Paint Scheme)	100%	50	14 h	7 h	4 h	10	5

Annexure - 02 Expression of Interest

Abraj Energy Services S.A.O.G.	
FROM:	Supply Chain Department
DOCUMENT:	AES-02 / Expression of Interest
TENDER REFERENCE	STC.251211.OPS.8000577, Rate Agreement for the Rebuild, Refurbishment, Repair, Renovation, and Upgrade of Rig 103, 104, 105, 201, 202, 203, 204, Including Main and Mini Camp Facilities

Dear Sir/Madam,

You are hereby invited to express your interest (EOI) for the above mentioned tender and confirms the following:

To register your interest please complete the forms listed below duly signed by authorized signatory and submitted within three (3) days of reviewing the Invitation to Tender (ITT) to:

Contract@abrajenergy.com

1. Annexure-03 Interest to Participate in Tender and Confidentiality Declaration for Tender
2. Annexure-04 Declaration to Comply with Company Requirement

Please note that all submissions and communications pursuant to this EOI notice shall bear following caption the Tender Reference

Our pre-qualification and tendering processes shall follow your EOI. If we do not receive any response from you on or before the above mentioned date, you will not be eligible to participate in this tender.

Abraj takes this opportunity to wish you all the best and we hope to deal with you soon.

Regards,

Supply Chain Department

Abraj Energy Services S.A.O.G.

Annexure – 03 Interest to Participate in Tender and Confidentiality Declaration for Tender

Abraj Energy Services S.A.O.G.	
FROM:	Supply Chain Department
DOCUMENT:	AES-03 / Interest to Participate in Tender and Confidentiality Declaration for Tender
TENDER REFERENCE	STC.251211.OPS.8000577, Rate Agreement for the Rebuild, Refurbishment, Repair, Renovation, and Upgrade of Rig 103, 104, 105, 201, 202, 203, 204, Including Main and Mini Camp Facilities

Attention: Contracts Officer

Dear Sir/Madam,

Having reviewed the Tender Document our company would like to register our interest in bidding for above referenced tender.

We the undersigning party (hereinafter called the 'Bidder') hereby represents and warrants to ABRAJ ENERGY SERVICES SAOG, being a company incorporated under the laws of the Sultanate of Oman having its Head Office at Heights, Seeb, Muscat, P.O. Box 1156, Post Code 130, Sultanate of Oman (hereinafter called the 'Company') to be unconditionally bound by the following terms and conditions with respect to the receipt, review, and treatment of all information and documents provided to the Bidder by or on behalf of the Company, including but not limited to the Tender Documents, in connection with the Tender Reference mentioend above.

1.1. Confidential Information shall mean all knowledge, data or information in connection with this Tender or the Project, which from time to time may be disclosed to the Bidder by Company, or on behalf of Company, in writing, including drawings, magnetic tapes, computer programs or in any other way, as well as all knowledge, data or information derived there from, to the extent that such knowledge, data or information at the time of such acquisition or disclosure is not either already in the unrestricted possession of Contractor or part of public knowledge or literature.

1.2. Confidential Record shall mean all documents and any other material containing Confidential Information.

2.1. The Bidder shall:

- (a) preserve and cause its employees, potential Subcontractors and Manufacturers to preserve the secrecy of any Confidential Information;
- (b) not disclose, except with the prior written consent of the Company, to any Third Party any Confidential Information or Confidential Record or enable any Third Party to note the fact that the Bidder has been invited to submit a Tender for the work for any purpose other than the performance of the work or the preparation and submission of a Tender for the work;
- (c) not, except with the prior written consent of the Company, reproduce, copy or use, or disclose to, place at the disposal of or use on behalf of any Third Party or enable any Third Party to peruse, copy or use, any Confidential Information for any purpose other than the performance of the work or the preparation and submission of a Tender for the work.

2.2. The Bidder may disclose Confidential Information or Confidential Records as required by law or to a court or tribunal of competent jurisdiction if an order for such disclosure is made and, in those

circumstances, only to the extent necessary by law or to satisfy such order for disclosure. The Bidder shall notify the Company prior to any such disclosure and shall provide all reasonable assistance as may be requested by the Company to prevent or minimize such disclosure.

- 2.3. The undertakings under Clause 2.1 above shall continue so far as the Confidential Information in question has:
 - (a) not become part of public knowledge or literature, or
 - (b) not been disclosed to the Bidder by a Third Party (other than one disclosing on behalf of the Company) whose possession of such information is lawful and who is under no secrecy obligation with respect to the same.

- 3.1. All intellectual property rights, including but not limited to copyright, patents, trademarks, moral rights and industrial design rights in any Confidential Record shall, in the absence of any express provision to the contrary thereon, be vested in the Company.

- 4.1. In the event that it is decided by the Company that the tendered work will be entrusted to another Bidder, or if the tender process is terminated or suspended by the Company for any reason whatsoever, the Bidder shall, upon receipt of a written notification thereof from the Company, return to the Company the Tender Documents as well as any Confidential Record pertaining thereto and delete any electronic record thereof in Bidder’s possession.

- 5.1. The Bidder shall ensure that if, under the terms of this Confidentiality Declaration, any of the Confidential Information comes to the knowledge of and/or into the possession of any Third Party, the Bidder shall require from such Third Party that it shall abide by identical stipulations to those contained in this Confidentiality Declaration.

- 5.2. Notwithstanding the above clause 5.1, the Bidder shall at all times remain liable to Company for any breach of the obligations under this Confidentiality Declaration, irrespective of whether or not the disclosure is actually caused by the Bidder or a Third Party to whom the Bidder has disclosed the Confidential Information.

- 6.1 This Confidentiality Declaration shall be governed by and construed in accordance with the Laws of the Sultanate of Oman.

- 6.2 In the event of a dispute arising under or in connection with this Confidentiality Declaration, including with respect to the existence, operation or validity of this Confidentiality Declaration, such dispute shall be resolved by arbitration in accordance with the arbitration proceedings and shall be conducted in the English language and the seat of the arbitration shall be Muscat, Sultanate of Oman.

Yours faithfully for:

Signature & date:

Full Name:

Position:

Stamp of Bidder

Annexure – 04 Declaration to Comply with Company Requirement

Whereas M/s. confirm to comply with company requirements as per below checklist:

Item Description	Required by Company (Yes/No)	Supplier Confirmation (Yes/No)	Comments
Compline to Abraj Terms and Conditions	Yes		
Tender Fees	No		
Bidder to Submit Tender Bond as per clause 2.15 of this document	No		
Bidder to Submit Performance Bond as per clause 2.16 of this document	Yes		
Bidder to Submit Advance Payment Bank Guarantee (if any advance payment requested)	Yes		
Bidder to submit Omanisation Certificate	Yes		

Failure to comply with the above checklist will result in Bidder being disqualified from the tendering process.

Agreed and accepted this Day of..... [Insert year]

For and on behalf of Bidder:

Annexure – 05 Form of Tender Bond

Abraj Energy Services (SAOG)
 Heights, Seeb, Muscat, P.O. Box 1156, Post Code 130
 Sultanate of Oman

Tender Bond No.

By this bond we.....whose address
 is.....hereby guarantee
 Messrs.....
 of..... and hold at your
 disposal the sum of R.O.
 being1.....% of the Tender Value from untila total period of ninety
 (90) calendar days.

This bond shall be free of interest and payable in cash on your first written demand in the event of the Bidder
 either withdrawing his Tender within a period of (90) calendar days from the date for the receipt of Tenders
 or failing to provide a Performance Bond within ten (10) working days of acceptance of the Tender
 whichever date is earlier without any reference to or contestation on behalf of the Contractor.

This bond should be returned to us upon its expiry or upon fulfilment of our undertaking, whichever is the
 earlier.

Authorized Signatures

(To be issued by a locally registered bank)

Annexure – 06 Form of Performance Bond

[LETTERHEAD OF BANK]

Guarantee No. [Insert]

[Date]

[Insert Name]

Attention: [Insert]

[Insert Address]

[Insert Address]

Subject: **Bank Guarantee/Performance Bond**

Contract No. [Insert] dated [Insert] between Abraj Energy Services and [Insert Name of Contractor]

WHEREAS, [Insert name of Contractor], having its office at _____ (the "Contractor") and Abraj Energy Services LLC (the "Company"), have entered into Contract N. [Insert] dated [Insert] (the "Contract") on the condition that the Contractor provides the Company, upon execution of the Contract, an unconditional, irrevocable on-demand guarantee by [Insert Name of the Bank], [Insert Address of the Bank] ("Guarantee") in order to guarantee the fulfilment by the Contractor of all of its obligations under the Contract.

NOW THEREFORE, we, [Insert Name of the Bank], having its registered office at [Insert] (the "Guarantor"), on condition that the Company and the Contractor, in fact, enter into the Contract, do hereby unconditionally and irrevocably undertake and guarantee to pay the Company an amount or amounts up to [Insert amount 5% of the value of the contract], the exact amount or amounts to be solely determined by the Company, immediately upon first written demand by the Company for any such amount or amounts, notwithstanding any objection or contestation by the Contractor.

The Guarantor hereby waives any right it may have to first require the Company to proceed against or enforce any other rights or other guarantee or security with respect to or claim payment from the Contractor before making a demand against or claiming from the Guarantor hereunder. Furthermore, the Guarantor's obligations hereunder shall not be exonerated by the following described actions, circumstances, matter or thing which, but for this provision, might operate to release or otherwise exonerate the Guarantor from its obligations, including without limitation and whether known or not known to the Guarantor or the Company:

1. Any amendment, modification, extension, indulgence, time, waiver or concession granted to the Contractor, whether as to payment, time performance, or otherwise, under the Contract;
2. Any legal limitation, disability, incapacity or other similar circumstances relating to the Contractor; and/or
3. Any unenforceability or invalidity of any of the Contractor's obligations to be performed by it under the Contract.

This Guarantee shall be governed by and shall be construed in accordance with the laws of [the Sultanate of Oman], except for the conflict of law principles that would cause the laws of another jurisdiction to apply.

This Guarantee shall be valid from the date first above written and shall remain in full force and effect for [insert date or duration]. Upon expiry of the said [date/duration], the Guarantee shall be null and void without the necessity of it being returned to us.

Yours faithfully,
[Insert Name of the Bank],

Signed by: _____

Name: _____

Title: _____

And Authorized Signatory

Annexure – 07 Form of Advance Payment Bond

Abraj Energy Services (SAOG)

Heights, Seeb, Muscat, P.O. Box 1156, Post Code 130

Sultanate of Oman

Advance Payment Bond No.....

Whereas M/s (Hereinafter called the Contractor) has been awarded a Contract dated for implementation, completion and maintenance of Project as described in the contract for the total Contract Price of R.O. (Omani Rials Only) and in consideration of your making an advance payment of R.O. (Omani Rials Only) to the Contractor being (10%) of the Contract Price, by this bond, we whose address is guarantee to pay you a sum not exceeding R.O. (Omani Rials Only) on your first written demand without any reference to or contestation on behalf of the Contractor.

It is understood that our liability towards you will be progressively reduced by the amount repaid to you by the Contractor as contained in the Certificates and Payment against the said advance payment.

The bond will be effective from and shall be valid until, or until the amount of advance payment is fully recovered, whichever occurs later.

This bond should be returned to us upon its expiry or upon fulfillment of our undertaking whichever is the earlier.

Authorised Signatories

(To be issued by a locally registered bank)

Place:

Date:

Annexure – 08 In Country Value (ICV)

1- Workforce: Number of Omanis Employed

Table A - : WORKFORCE related to execution of this specific contract duration with details of Main/Lead Contractor or Sub-Contractor.													
	Workforce Category	Senior Management			Professional			Supervisory			Skilled/Semi Skilled		
		HD	MH	CP	HD	MH	CP	HD	MH	CP	HD	MH	CP
Contractor	Omanis												
	Expatriate												
Sub-Contractor	Omanis												
	Expatriate												

2- Use of Local Goods/Services

Bidder must provide details in the format below showing local goods/services proposed to be utilized in the performance of the Services. If none: Bidder shall so state.

a- Goods Made-in-Oman

#	Goods Description	Manufacturer /Provider	Address	Quantity	% of total quantity sourced from local manufacturer	Total value of local manufactured goods
1						
2						
3						

b- Goods Procured in Oman

#	Goods Description	Location of International Manufacturer	Local Supplier Address	Quantity	% of total Contract quantity to be local supply	Total value of local manufactured goods
1						
2						
3						

Summary of Tables A & B		
Total Value of Goods Made in Oman (OMR / USD)	Total Value of Goods Procured in Oman (OMR / USD)	Total Value of Goods Procured from Overseas (OMR / USD)
\$0	\$0	\$0

c- Local Services Obtained in Oman

#	Type of Service	Proposed Subcontractor Address	Value added	% of total Contract value
1				
2				
3				
4				

Summary of Tables C	
Total Value of Local Sourcing (USD / OMR)	Total Value of Overseas Sourcing (OMR / USD)
\$0	\$0

ICV Terminologies/Definitions

Table B - Work Force

HD stands for Headcount: "Headcount" means the number of full-time equivalent employees or in-house Contractors/agency staff within the Contractor or 3rd Party Sub-Contractor who will be involved in execution of the Contract.

MH stands for Man-hours: "Man-hours" means the number of hours of work undertaken in execution of the Contract (only the actual hours written, or to be written, to Contract execution are included).

The method of calculation and reporting is as follows;

$MH = \text{Contract Duration} \times \text{number of headcount of that category}$

For example, contract awarded for a period of 4 years, with 2 professional resources working full time on the execution of the contract:

$4 \text{ years} \times 12 \text{ months} \times 30 \text{ days} \times 8 \text{ hours} \times 2 \text{ professionals} = 23,040 \text{ Manhours}$

CP stands for Compensation: "Compensation" means the sum of Man hours multiplied by an average all-inclusive average hourly rate. Average hourly rate calculated from Gross Salaries pro rated.

The currency shall be in USD.

For example, contract listed the 2 headcount Professional as Drilling Engineer and Chemical Engineer with a monthly salary of \$2,000 and \$1,800 respectively. The total monthly salary shall be inclusive of PASI and other permanent allowances such Housing and Transport allowance.

The formula to calculate the average hourly compensation rate will be as follows:

Drilling Engineer Monthly salary divided by man-hours working per month: $2000 \text{ USD} / (22 \text{ days} \times 8 \text{ hours}) = 11.4 \text{ USD as hourly rate}$

Chemical Engineer Monthly salary divided by man-hours working per month: $1,800 \text{ USD} / (30 \text{ days} \times 8 \text{ hours}) = 7.5 \text{ USD as hourly rate}$

Total hourly rate for both resources = $11.4 + 7.5 = 18.9$

Average hourly rate for both resources = $18.9 / 2 = 9.5$

The compensation per hour as calculated above to be included shall 9.5 USD/hour

JOB POSITIONS

6. "Senior Management" means a member of the decision-making executive of a function within Contractor or sub-Contractor Company. -CEO and all managers titles who reported to CEO. HR Managers, Admin manager, finance manager, project manager .etc..

7. "Professional" means an individual who has completed bachelor degree related tertiary education and achieved professional certifications status within a professional body. Includes chartered engineers and accountants, lawyers, architects, procurement professionals and Engineer.

8. "Supervisory" means a worker who manages a team of at least two subordinates (but who is not considered part of the Senior Management team, nor a Professional). Supervisors include construction foreman, equipment overseers, business administration team leaders etc.

9. "Skilled" means a worker with a high level of technical expertise accumulated over a number of years (but not a member of a recognised 'profession'). A skilled worker may have attended a Technical College or learned their skill via a formal apprenticeship or on-the-job over a number of years. Includes: electricians, scaffolders, welders, crafts, business admin, personnel assistants, computer programmers, equipment and machinery operators.

10. "Semi-skilled" means workers with a skill set acquired in a short space of time (a few weeks or months). Following short periods of training a casual labor may become semi-skilled, thus demonstrating how the Contract has contributed to human capacity in Oman. Semi-skilled positions include secretaries, drivers, meet and greet services, fencing, block laying, basic construction skills etc.

Annexure – 09 Clarification Request

Tender Reference: STC.251211.OPS.8000577, Rate Agreement for the Rebuild, Refurbishment, Repair, Renovation, and Upgrade of Rig 103, 104, 105, 201, 202, 203, 204, Including Main and Mini Camp Facilities

1	<u>Question Received XX/XX/XXXX</u> <u>Article X.X.X</u> ... <u>Company Response Dated XX/XX/XXXX</u> ...
2	<u>Question Received XX/XX/XXXX</u> <u>Article X.X.X</u> ... <u>Company Response Dated XX/XX/XXXX</u> ...
3	<u>Question Received XX/XX/XXXX</u> <u>Article X.X.X</u> ... <u>Company Response Dated XX/XX/XXXX</u> ...
4	<u>Question Received XX/XX/XXXX</u> <u>Article X.X.X</u> ... <u>Company Response Dated XX/XX/XXXX</u> ...

Annexure – 10 Pricing Schedule

- Commercial Table:

Service code	Description	Qty /Camp	Unit Cost	Total	Remarks
1010159	REPAIR, REFURBISHMENT, PAINTING OF A SINGLE MAN CABIN(WITH MATERIALS AS PER SOW), INCLUDES INSPECTION, STRUCTURE REPAIR, PAINTING, REDRESSING, REFURBISHING, AND INSTALLATION AND INTEGRATION AT THE SITE	80			
1010160	REPAIR, REFURBISHMENT, PAINTING OF A DOUBLE MAN CABIN(WITH MATERIALS AS PER SOW), INCLUDES INSPECTION, STRUCTURE REPAIR, PAINTING, REDRESSING, REFURBISHING, AND INSTALLATION AND INTEGRATION AT THE SITE	170			
1010161	REPAIR, REFURBISHMENT &PAINTING OF MASTERSKID, INCLUDES INSPECTION, REPAIR, PAINTING.	110			
1010162	SUPPLY AND INSTALL CENTRAL HEATER FOR EACH MEGA CABINS	175			
1010163	SUPPLY AND INSTALLATION OF LAUNDRY EQUIPMENT, SUCH AS WASHING MACHINES AND DRYERS, ETC.	7 LOT			
1010164	SUPPLY AND INSTALL FOR CENTRALIZED FIRE ALARMS WITH ASSOCIATED SENSORS FOR MAIN CAMP	7 LOT			
1010165	SUPPLY AND INSTALL FOR CENTRALIZED FIRE ALARMS WITH ASSOCIATED SENSORS FOR MINICAMP	7 LOT			
1010166	REPAIR, REFURBISHMENT &PAINTING OF WATERTANK, INCLUDESINSPECTION, REPAIR, PAINTING, ANDREDRESSING THE TANK WITH FULL ACCESSORIES SUCH AS PUMP, WATERCHILLER,	14 Set			
1010167	SUPPLY OF ELECTRIC AND PLUMBING, CARPENTRY ITEMS, AND WORKS, AND PROVIDE INSTALLATION, INTEGRATION, AND COMMISSION AT THE SITE	7			

Contract Period	2 years + 1 year
Delivery Period	
Delivery Term	
Payment Term	
Bid Validity	90 Days

Annexure - 11 Tender Strategy for Evaluation of bid

Abraj Management had followed the tendering strategy as per the tender procedure which forms part of the Abraj Tender Policies and Procurement (ATPP).

The process followed was the following:-

1. Tender for purchase of equipment and materials or availing of Services and includes Purchase Order, Service Order or other arrangement will sent seeking Technical and commercial bids in a two separate sealed envelopes which are submitted in a sealed envelope or electronic mode.
2. The technical bids will evaluated as per the evaluation process defined below. We have tender opening protocol duly signed by the authorized persons as per ATPP.
3. The Commercial bids will opened for the technical qualified bidders only.
4. The Commercial bids will be reviewed and evaluated. The best offer will be awarded the Contract after evaluation and approval from Abraj Management Team.
5. Letter of Intent (LOI) has been issued to the successful bidder followed by execution of Contract wherever required.

Process for Evaluation of bid

The Technical Evaluation Process for the different types of bids will be carried out in the following steps:

1. Opening of the Technical Bids.
2. Analysis of the Technical Bids.
3. Gather all missing information from the technical bids.
4. Sending clarifications to those bidders who have not been disqualified initially.
5. Receive clarifications.
6. Set weightage for scoring based on importance of each evaluation criteria.
7. Evaluate data and score.
8. Finalize Technical Evaluation.
9. Minimum Technical Score to be obtained is 75 % to be Eligible for getting qualified for Commercial Bid Evaluation. For bidders who are technically disqualified, their commercial bid will not be opened.
10. Whoever is technically qualified, all are treated at par for commercial evaluation and L-1 bidder would be awarded the contract.

11. The Company reserves the right to award the contract in the best interest of the company to any bidder other than L-1 without assigning any reason whatsoever.

Technical Methodology

At first, Bidders shall be evaluated on technical proposals in accordance with Evaluation Criteria as described in the Tender Document.

Each of technical proposals shall be evaluated on the basis of the Bidder's degree of compliance, with requirements as specified in the Tender Document including the Specifications. Bidder who achieves the Technical evaluation threshold will be evaluated commercially.

The evaluation shall consist of

Technical Proposal Evaluation

Financial Proposal Evaluation

Compliance Requirement

Criteria			Yes/No
1	Close out all points raised while commission and final accept prior to deliver the system.	Commitment to close all observations (100%) during FAT/Commissioning prior to final acceptance and delivery of the system.	
2	Certified welders	All Welders performing welding jobs shall be certified, as per standard requirement of API and their welding certificate shall be submitted along with bid submission	
3	Electrical Standard comply	Design electrical systems strictly in accordance with IECEx and ATEX standards	
4	Design and Construction standards	The mobile camp shall be designed and constructed in accordance with the standards and specifications : SP-1110 Specification for Electrical Supplies to Mobile Camp SP-1277 Transportable Accommodation Units OPAL Standard	
5	Deployment of skilled manpower	Commitment to deploy only skilled and experienced personnel on job, especially Electricians; the company reserves the right to audit and interview personnel engaged in the project and terminate the contract if bidder fails to maintain its commitment	
6	Lead time for Delivery, DDP/CIF (Muscat/Oman)	Bidder Commitment to deliver each camp in line with the Scope of Work within 8 weeks of the date of receipt of the PO.	

7	Warranty	Bidder shall commit to providing a minimum of 12 months' warranty from the date of use of Camp accessories and 10 years for the structure.	
8	Experience	Bidder shall have experience with Abraj or any other drilling companies in Oman in the fabrication of at least 3 camps, and 5 years of industry experience in MOH and building Camps.	

Technical Criteria:

No	Criteria Description	Weightage %
1	Provided extended warranty for Camp accessories	15%
2	Experience within Abraj or any other drilling companies in Oman	35%
3	Experience in MOH and building Camps.	35%
4	Delivery Schedule	15%

Cut off 75%**Note: Bidders who have any deviations, are required to fill annexure 12 & 13.**

Annexure – 12 Deviations Form-Technical Submission

As a base requirement, the Bidder's proposal shall fully comply with Abraj's Contract including its Terms and Conditions. No deviations or exceptions shall be considered valid unless expressly stated in compliance with this form and submitted before the bid closing date.

Bidders are advised that Abraj will take into consideration the extent of any exceptions taken by the bidder during the evaluation of the bid.

Deviation form submission instructions:

1. For Fully Compliant Bidders

If your organization is fully compliant with the Contract including the terms and conditions and its annexures, please keep the table below blank, sign and stamp this document and tick the applicable box at the bottom of this form.

2. For Bidders with Exceptions or Deviations

If your organization has any exceptions or deviation to any part of the Contract including its Terms & Conditions, please provide all exceptions in a Microsoft Word compatible format as a table using the following column structure. The bidder is required to tick the appropriate box at the bottom of this form, and to stamp and sign it.

Clause number	Original clause wording	Exception/ deviation	Reason for Exception/ deviation	Cost impact on price, schedule (YES/NO)

Important Notes:

- Any deviation request submitted post tender submission deadline will not be considered and may lead to disqualification.
- The Bidder shall clarify the cost impact if any against each deviation. ONLY INDICATE IN THIS FORM (YES/NO) IF THERE IS COST IMPACT.

The cost impact values in OMR to be filled in **Deviations Form-Commercial Submission**

- An example for deviation request.

Article #	Article Clause	Exception/ deviation	Reason for Exception/ deviation	Cost impact on price, schedule (YES/NO)
8.1	The Consultant's Fee shall be inclusive of all taxes, levies and assessments pertaining to the Services, but	State the deviation	Reasons to be filled by the Bidder.	YES

	exclusive of value added tax,			
--	--	--	--	--

By signing this form, we confirm that we have reviewed the entire Abraj Contract, including Terms & Conditions and annexures and we confirm that:

- ☐ Our organization is fully compliant with the Contract including the Terms and Conditions and annexures.

OR

- ☐ Our organization is not fully compliant with one or more provisions of the Contract.
Therefore, we have submitted a Deviation Table in compliance with this form, detailing each exception or deviation, along with the reason and any associated cost or delivery impact.

Authorized signatory Name:

Signature:

Date:

Stamp:

Annexure – 13 Deviations Form-Commercial Submission

As a base requirement, the Bidder's proposal shall fully comply with Abraj's Contract including its Terms and Conditions. No deviations or exceptions shall be considered valid unless expressly stated in compliance with this form and submitted before the bid closing date.

Bidders are advised that Abraj will take into consideration the extent of any exceptions taken by the bidder during the evaluation of the bid.

Deviation form submission instructions:

3. For Fully Compliant Bidders

If your organization is fully compliant with the Contract including the terms and conditions and its annexures, please keep the table below blank, sign and stamp this document and tick the applicable box at the bottom of this form.

4. For Bidders with Exceptions or Deviations

If your organization has any exceptions or deviation to any part of the Contract including its Terms & Conditions, please provide all exceptions in a Microsoft Word compatible format as a table using the following column structure. The bidder is required to tick the appropriate box at the bottom of this form, and to stamp and sign it.

Clause number	Original clause wording	Exception/ deviation	Reason for Exception/ deviation	Cost impact on price, schedule (Price in OMR)

Important Notes:

- Any deviation request submitted post tender submission deadline will not be considered and may lead to disqualification.
- The Bidder shall clarify the cost impact if any against each deviation. The cost impact is the reduction in the rate which the Bidder will provide in case Abraj accepts the deviation request.
- The cost impact will be considered in the Bidder's commercial evaluation.
- An example for deviation request with commercial evaluation impact;

Article #	Article Clause	Exception/ deviation	Reason for Exception/ deviation	Cost impact on price, schedule (Price in OMR)
8.1	The Consultant's Fee shall be inclusive of all taxes, levies and assessments pertaining to the Services, but exclusive of value	State the deviation	Reasons to be filled by the Bidder.	A reduction of OMR 3,000 in total price

	added tax,			
--	------------------	--	--	--

If Bidder's commercial evaluation resulted to a contract value of = 40,000 OMR, then the impact of deviation will be;

- Final contract value of 40,000 OMR if Abraj did not accept the deviation.
- Final contract value of 37,000 OMR if Abraj did accepts the deviation.

By signing this form, we confirm that we have reviewed the entire Abraj Contract, including Terms & Conditions and annexures and we confirm that:

- ☐ Our organization is fully compliant with the Contract including the Terms and Conditions and annexures.

OR

- ☐ Our organization is not fully compliant with one or more provisions of the Contract.
Therefore, we have submitted a Deviation Table in compliance with this form, detailing each exception or deviation, along with the reason and any associated cost or delivery impact.

Authorized signatory Name:

Signature:

Date:

Stamp:

Annexure – 14 Standard Terms and Conditions